

TEMPLATE

OF SURFACE VERTICAL ROD DEVICE (1:1)

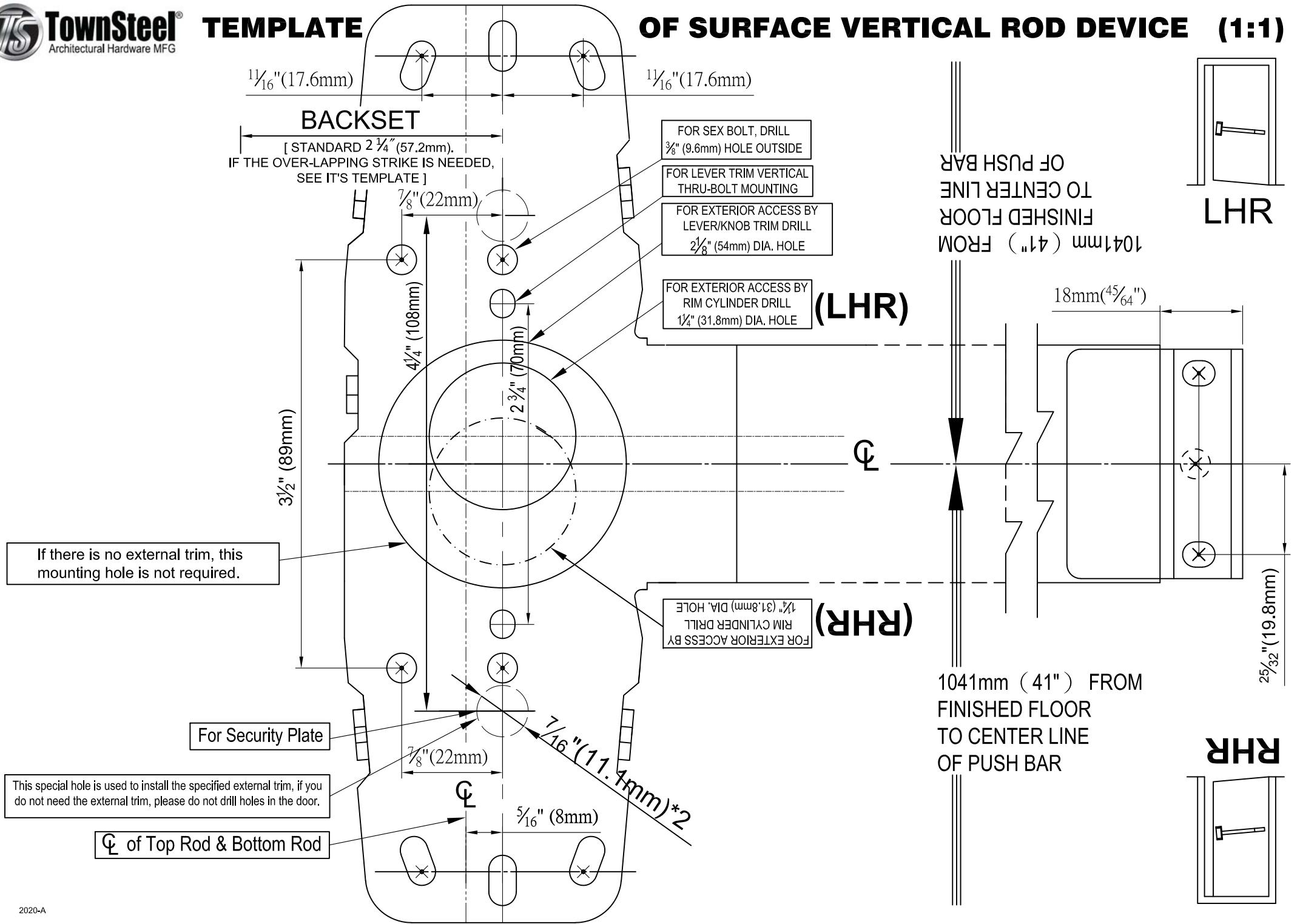

TEMPLATE of Bottom LATCH (1:1)

【Handicap Strike (Optional use)】

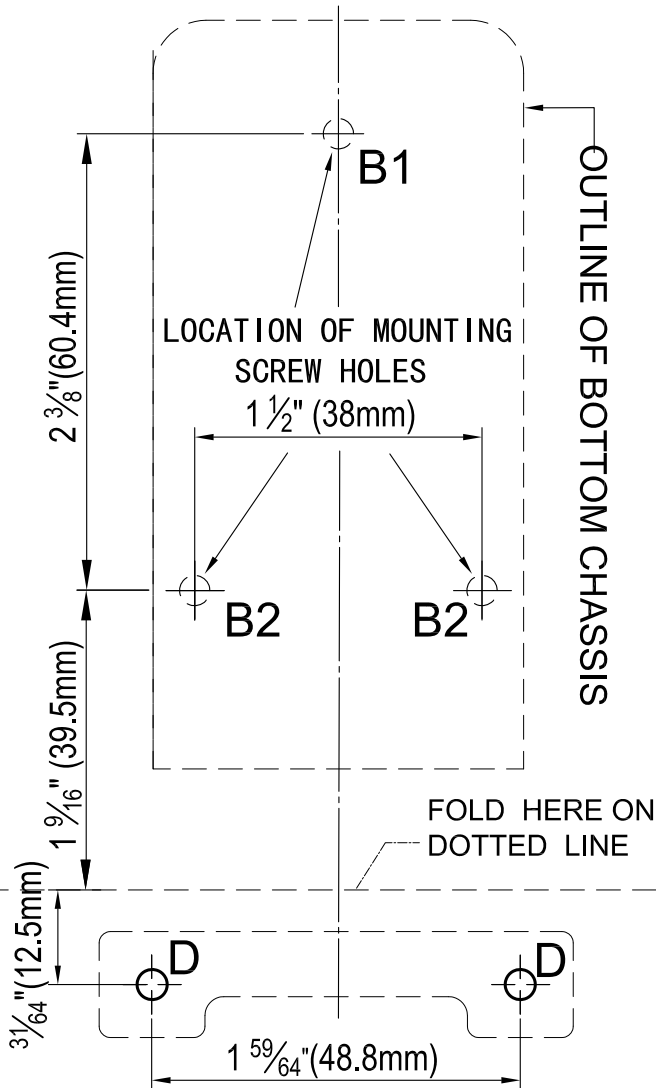
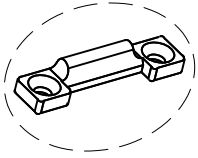

TEMPLATE of Bottom LATCH (1:1)

【Surface Strike (regular use)】

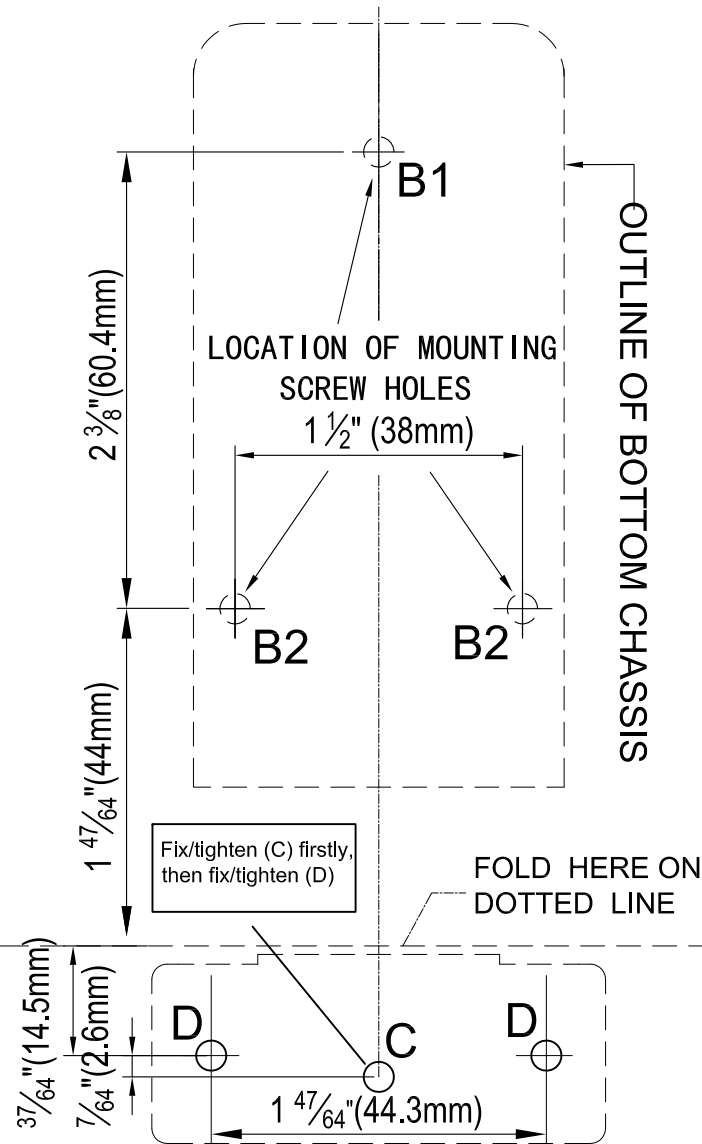
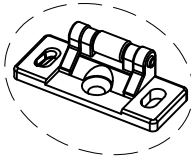

TEMPLATE of Top LATCH (1:1)

【Top Strike (regular use)】

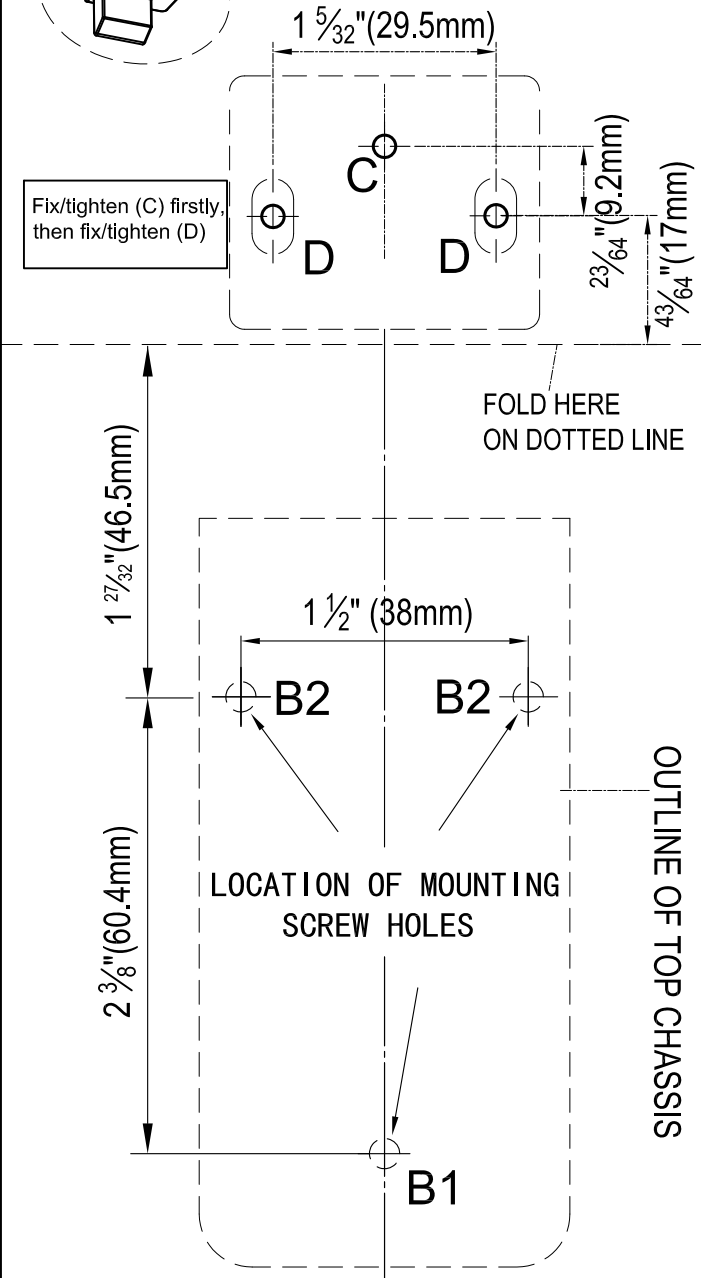
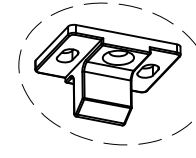

TEMPLATE of Bottom LATCH (1:1)

【Mortise in Strike (Optional use)】

