

# Installation Instructions

## Rim Device

### Determine handing of door

Right - Hand Reverse Bevel (RHR)

Left - Hand Reverse Bevel (LHR)

Outside

Outside

Push Side

Push Side

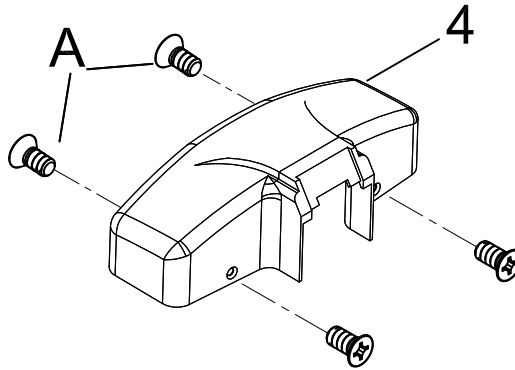
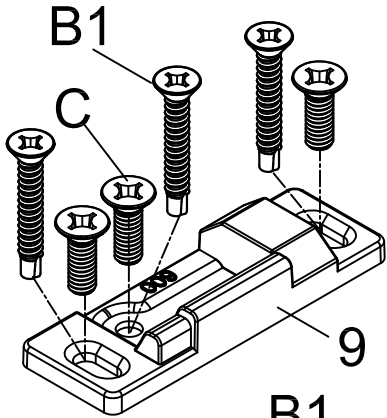
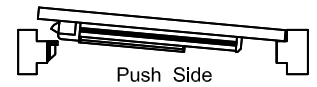
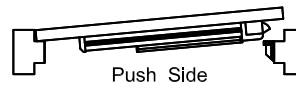

(Not available on fire-rated)

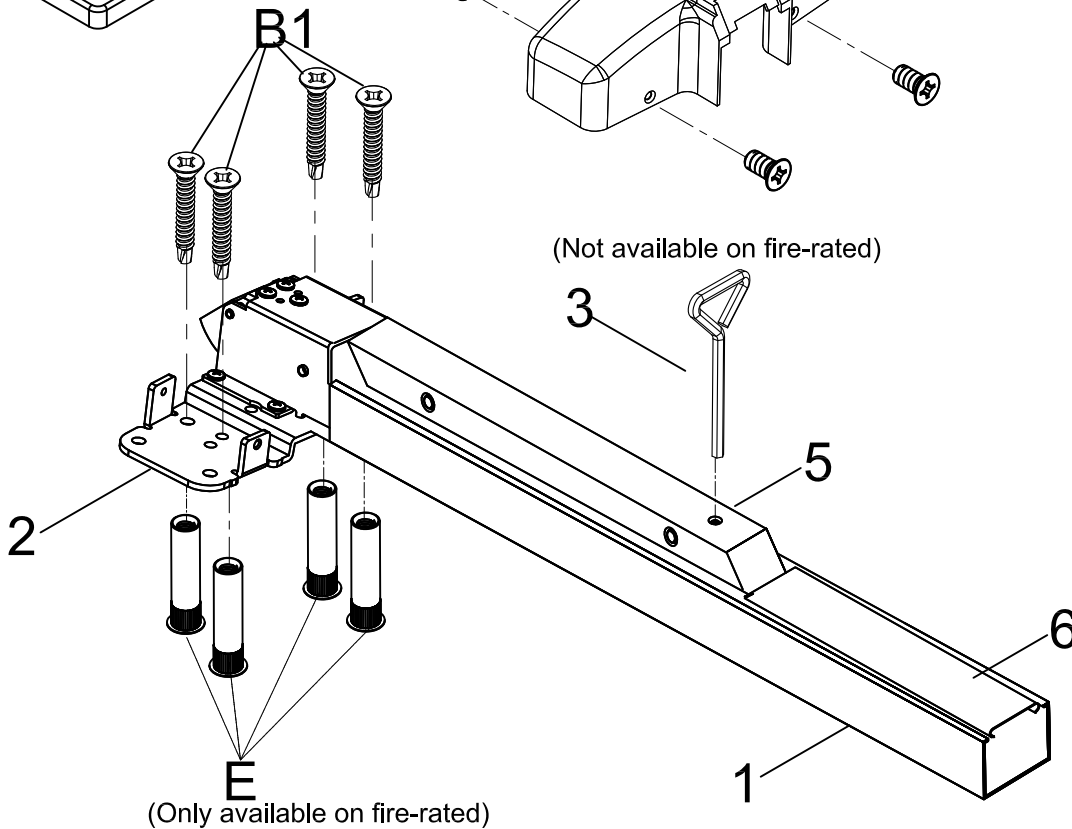

(Only available on fire-rated)

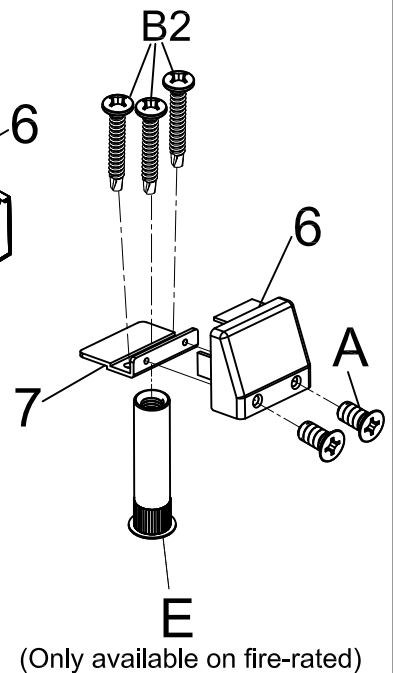

(Only available on fire-rated)

### PARTS LIST

ITEM	DESCRIPTION	Q'TY	
		Non-Fire	Fire
1	MOUNTING RAIL	1	
2	CHASSIS ASS'Y	1	
3	DOGGING HEX KEY	1	N/A
4	HEAD COVER	1	
5	PUSH BAR	1	
6	SLIDING COVER	1	
7	BRACKET	1	
8	END CAP	1	
9	STRIKE	1	
A	SM4X8 FLAT HEAD SCREWS	6	
B1	10#1 1/4" TEK SCREWS (FLAT HEAD)	7	3
B2	10#1 1/4" TEK SCREWS (ROUND HEAD)	3	2
C	12# 5/8" SCREWS (FLAT HEAD)	3	
D	12# 5/8" SCREWS (ROUND HEAD)	0	
E	SEX BOLT	N/A	5

## STEP 1: MARK CENTER LINES

※ If necessary, add strike shim under strike for  $\frac{3}{16}$ " (4.8mm) as dimension shown

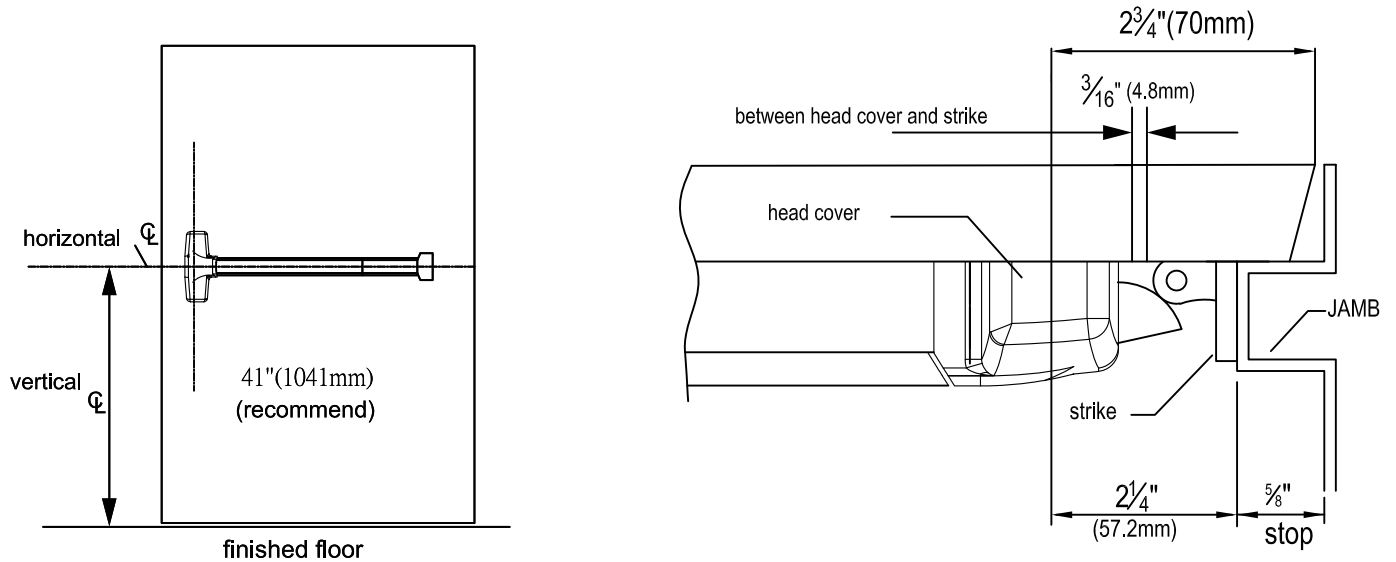

## STEP 2: PREPARE INSTALLATION

※ RHR shown (LHR opposite)

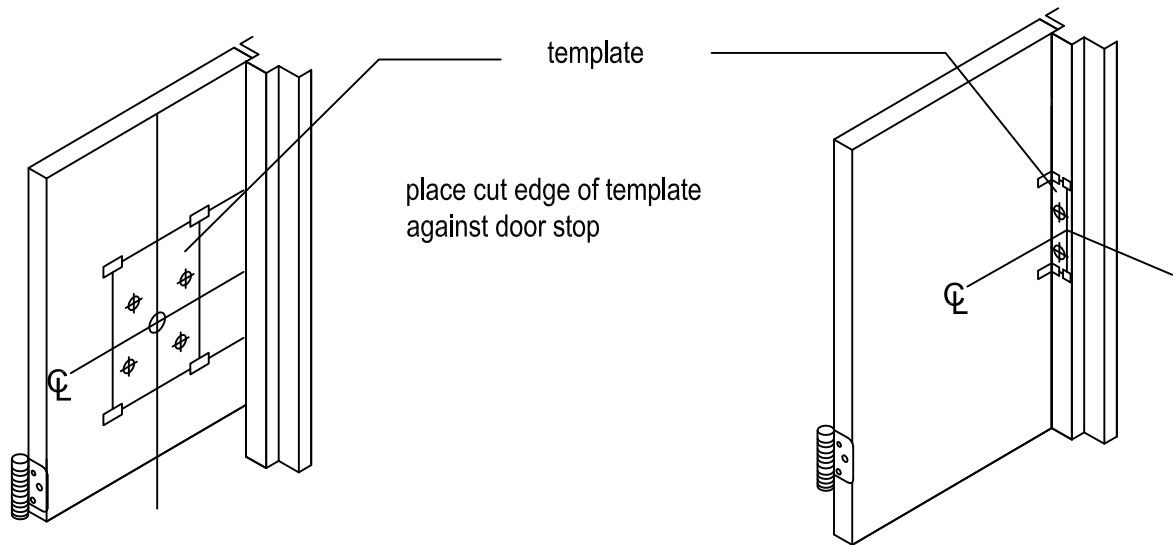

### Notice 1 : Tailpiece length

Keep tailpiece  $\frac{5}{16}$ "~ $\frac{1}{2}$ " (8~12.7mm) projected.

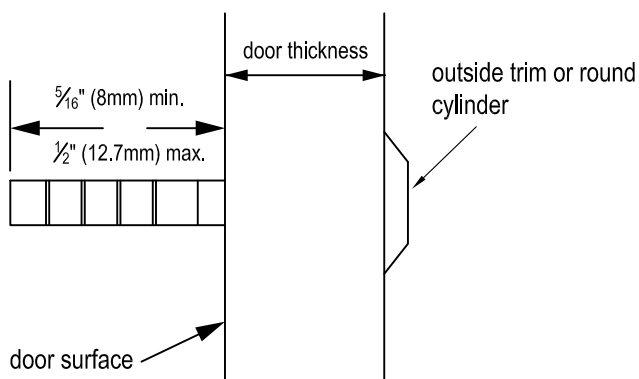

### Notice 2: Dogging (For non fire-rated)

To press down the push bar, turn the dogging hex key clockwise or counterclockwise, the device will change the function to "Passage".

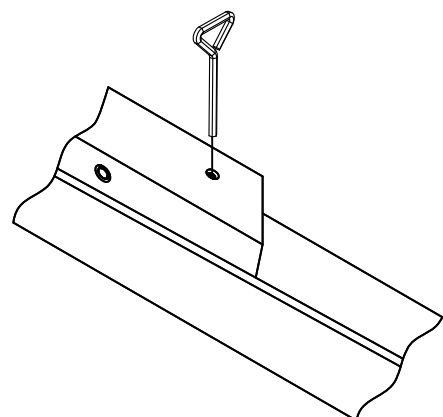

## STEP 3: CUT DEVICE IF REQUIRED

3.1 Device length A must be at least  $1\frac{1}{2}$ " (38mm) shorter than B

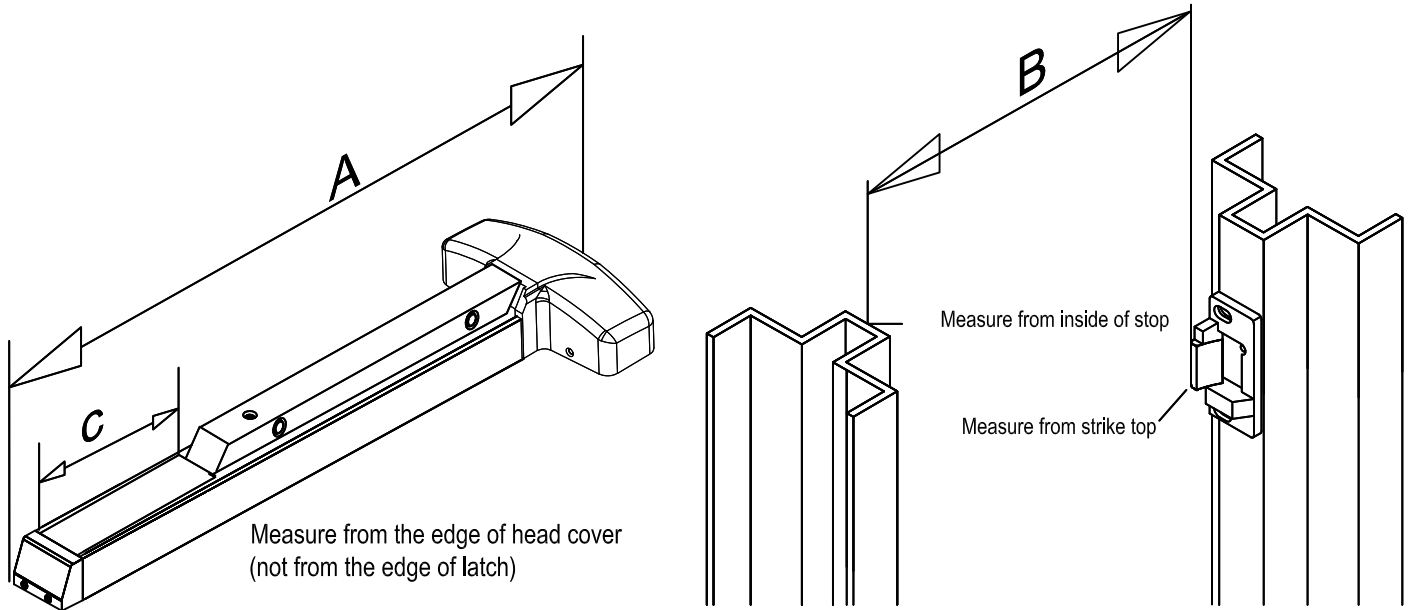

3.2 If required cut C length, so A is at least  $1\frac{1}{2}$ " (38mm) shorter than B.

Ensure no gap between sliding cover and push bar end.

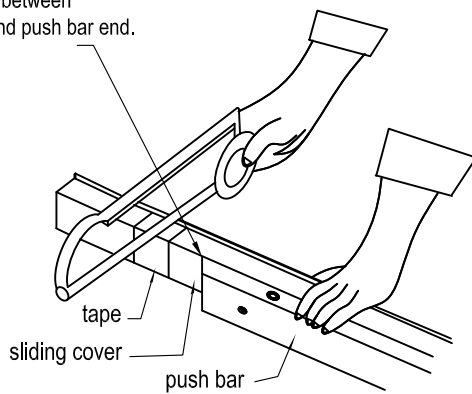

NOTE : the minimum length of the sliding cover must be 1" (25.4mm) or longer than length "C".

3.3 Standard Door Stop is  $\frac{5}{8}$ " (15.9mm). Install  $\frac{1}{8}$ " (3mm) strike shim if required.

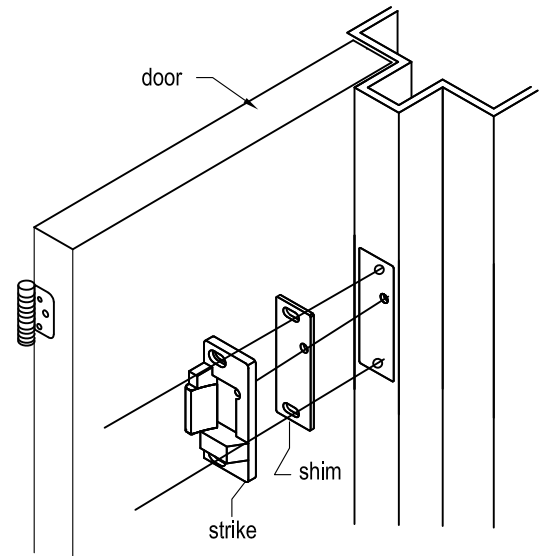

## STEP 4 : INSTALL DEVICE

- 4.1 Take off head cover and put device horizontally at the door. Fix screws (B1) on chassis but DO NOT tighten them at this step.
- 4.2 Install bracket with screw (B2). Be sure to remain device being horizontal and then tighten all screws.
- 4.3 Install end cap & head cover.

※ for "FIRE RATED" :  
please drill  $\phi \frac{3}{8}$ " (9.6mm) hole for sex bolt (E)

※ for "NON FIRE-RATED" :  
please use screw (B2) directly

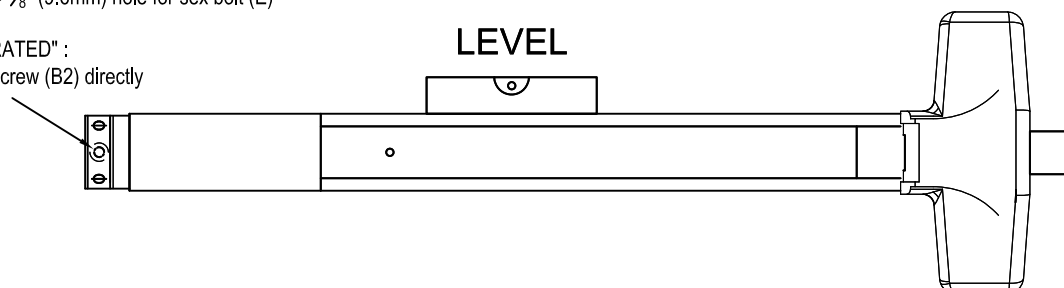

# Apply TRIM + CHASSIS

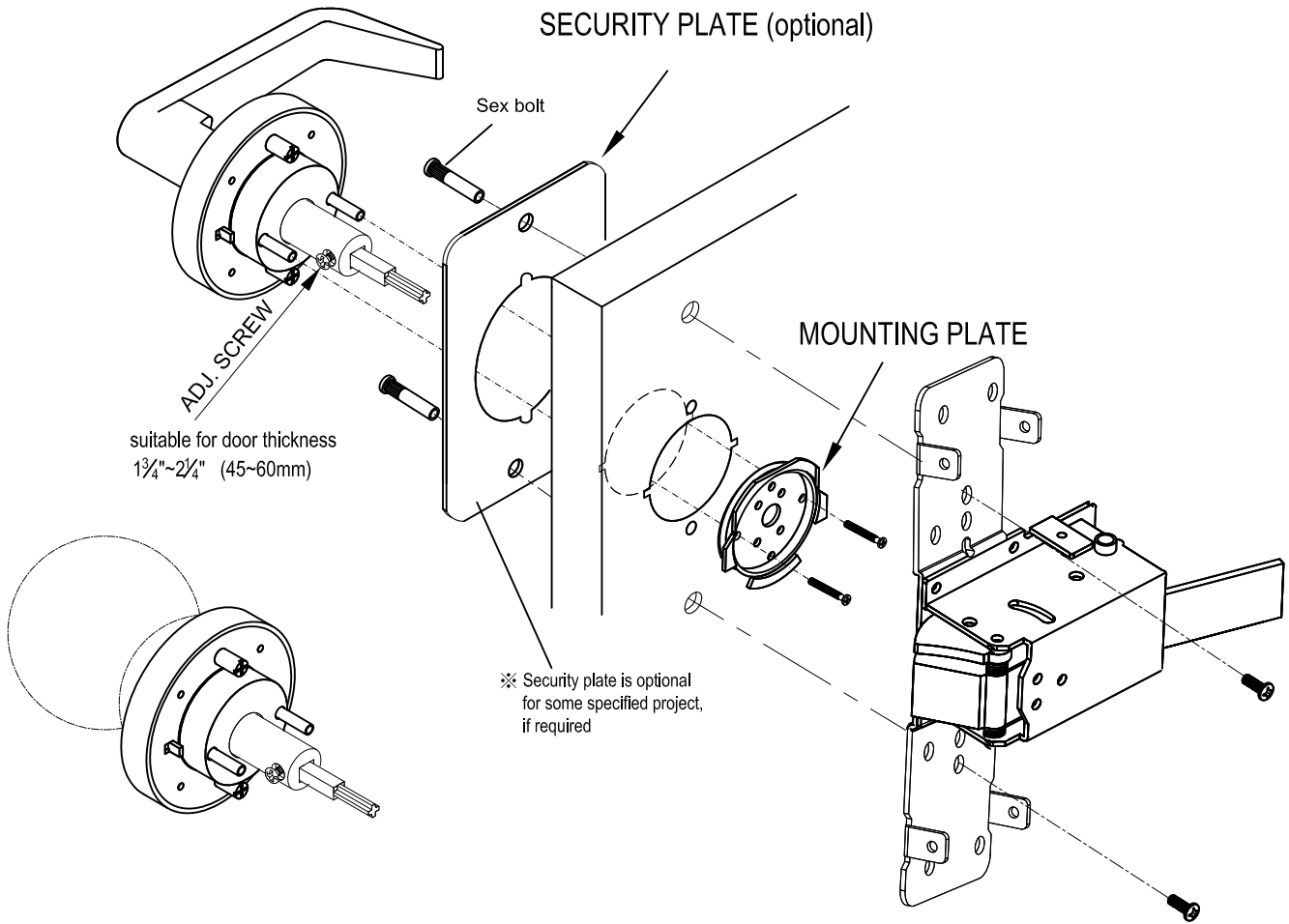

Thumbpiece trim

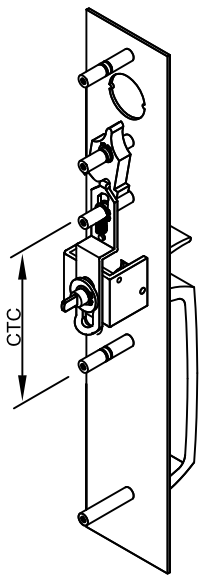

CTC = 4 1/4" (108mm)

Pull trim

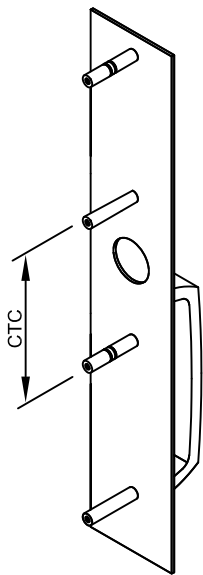

CTC = 4 1/4" (108mm)

Pull trim

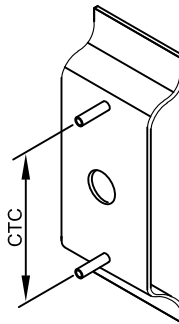

CTC = 3 1/2" (89mm)

ESC lever trim

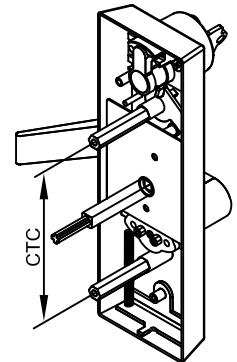

CTC = 4 1/4" (108mm)

Trim with security plate

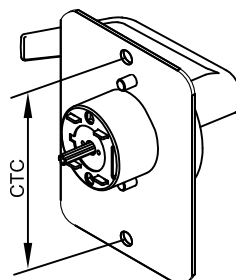

CTC = 4 1/4" (108mm)

Trim w/o security plate

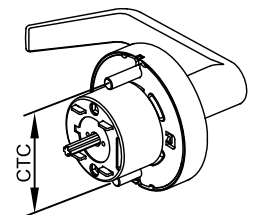

CTC = 2 3/4" (70mm)