

# Installation Instructions

## Narrow Stile Less Bottom Rod (LBR) Device



※ The screws (from item B to H), attach both machine & tapping screws for install selection in the accessory package.

### Determine handing of door

Right - Hand Reverse Bevel (RHR)

Outside

Push Side

Left- Hand Reverse Bevel (LHR)

Outside

Push Side

\*LHR as shown\*

### BEFORE INSTALLING DEVICE, PLEASE CHECK:

A. THE DOOR MUST BE HANGING CORRECTLY.

B. SIZE OF EXIT DEVICE, FUNCTION AND DESIGN....

B.1. 36" DOORS, CAN BE CUT TO FIT DOORS DOWN TO 30" WIDE.

B.2. 48" DOORS, CAN BE CUT TO FIT DOORS DOWN TO 36" WIDE.

B.3. HANDING OF DEVICE.

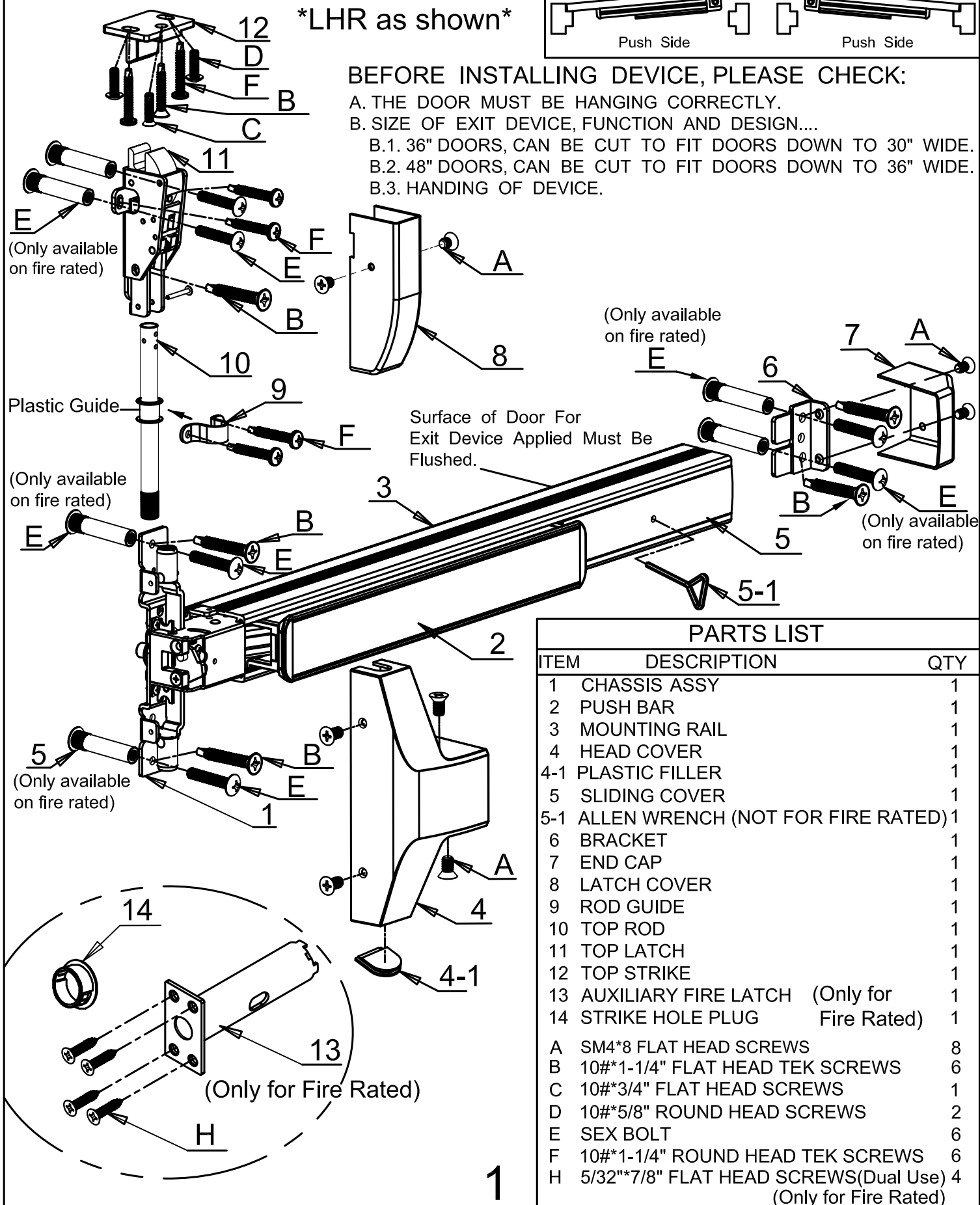

### PARTS LIST

ITEM	DESCRIPTION	QTY
1	CHASSIS ASSY	1
2	PUSH BAR	1
3	MOUNTING RAIL	1
4	HEAD COVER	1
4-1	PLASTIC FILLER	1
5	SLIDING COVER	1
5-1	ALLEN WRENCH (NOT FOR FIRE RATED)	1
6	BRACKET	1
7	END CAP	1
8	LATCH COVER	1
9	ROD GUIDE	1
10	TOP ROD	1
11	TOP LATCH	1
12	TOP STRIKE	1
13	AUXILIARY FIRE LATCH (Only for Fire Rated)	1
14	STRIKE HOLE PLUG	1
A	SM4*8 FLAT HEAD SCREWS	8
B	10#*1-1/4" FLAT HEAD TEK SCREWS	6
C	10#*3/4" FLAT HEAD SCREWS	1
D	10#*5/8" ROUND HEAD SCREWS	2
E	SEX BOLT	6
F	10#*1-1/4" ROUND HEAD TEK SCREWS	6
H	5/32"*7/8" FLAT HEAD SCREWS(Dual Use) (Only for Fire Rated)	4

# Narrow Stile Less Bottom Rod (LBR) Device

## STEP 1 : PREPARE INSTALLATION

Regularly furnished unless otherwise ordered.

INSIDE OF LHR DOOR IS ILLUSTRATED

\*Please follow template

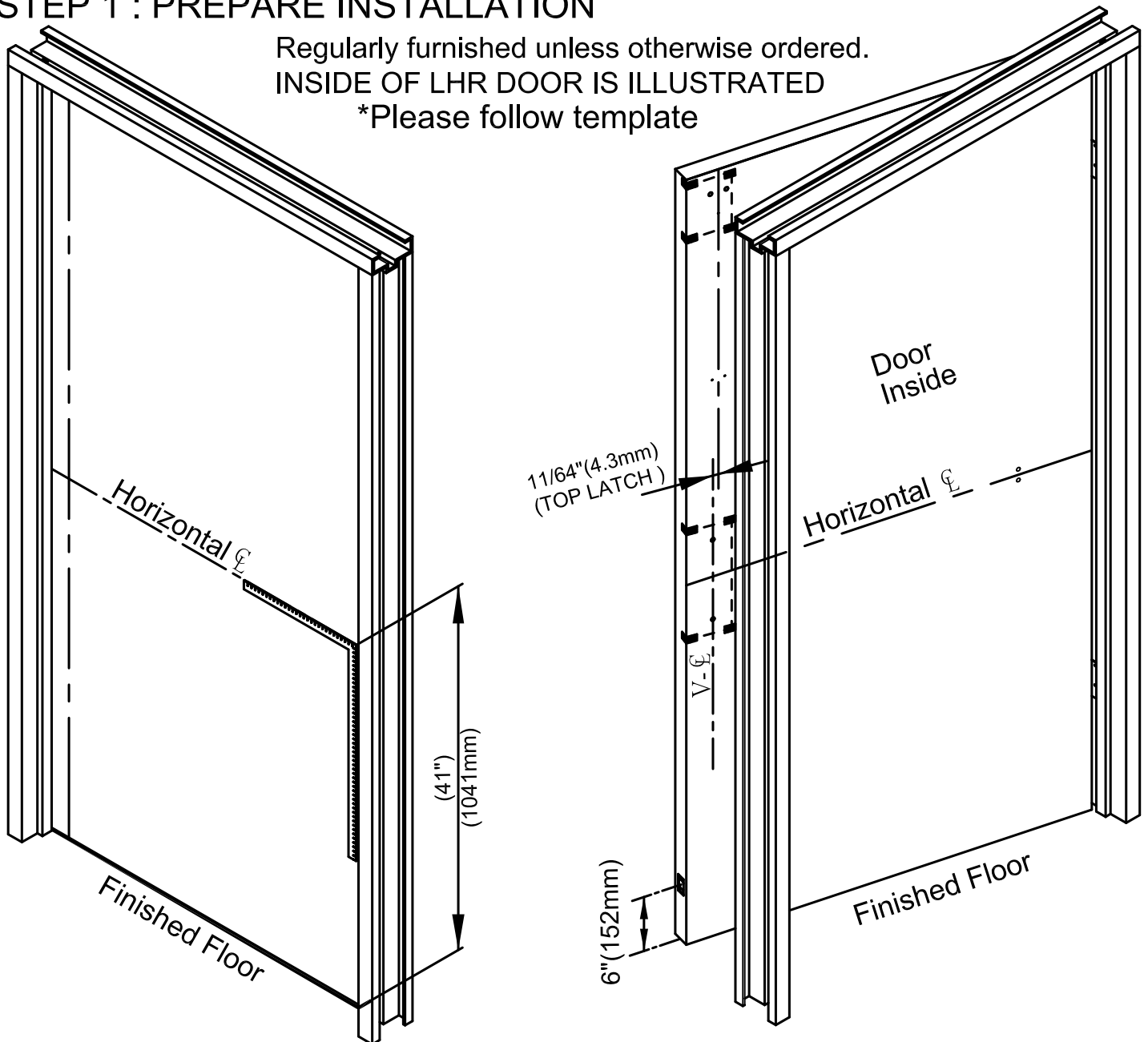

## INSTALL AUXILIARY FIRE LATCH FOR Less Bottom Rod (LBR) Devices ONLY

### STEP 2 : INSTALL AUXILIARY FIRE LATCH (Only for Fire Rated)

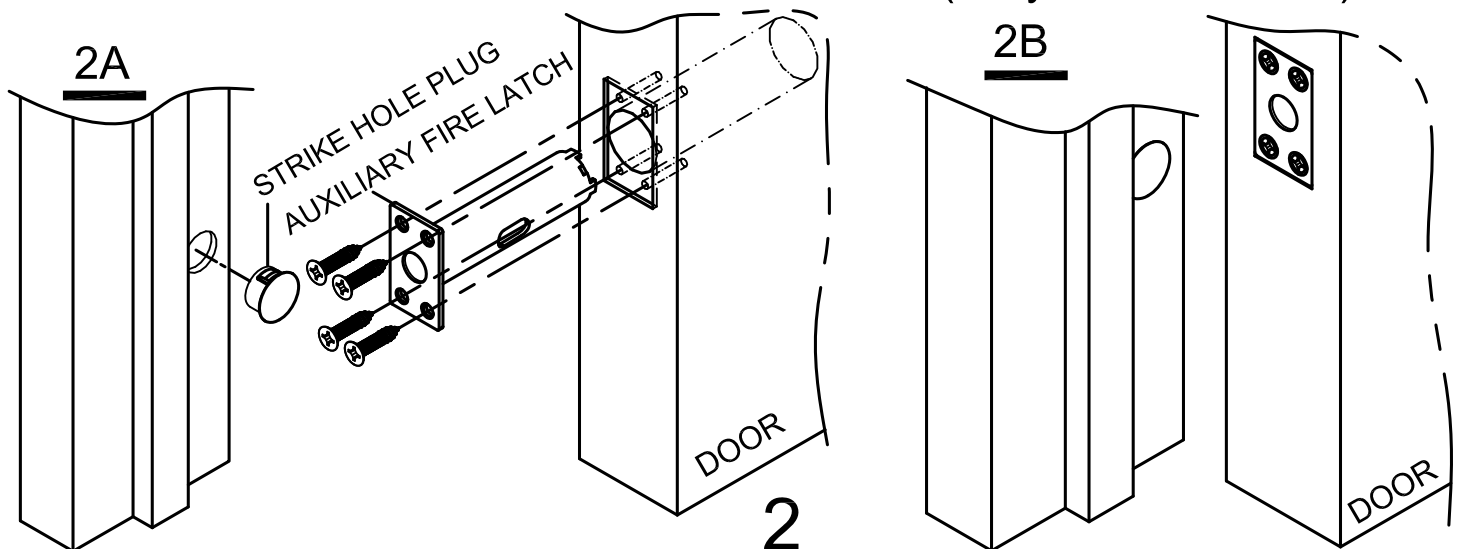

## STEP 3 : CUT DEVICE IF REQUIRED

3A. Device length A must be at least 1- 3/4" (45mm) shorter than B.

3B. If required, cut length C, so A is at least 1- 3/4" (45mm) shorter than B.

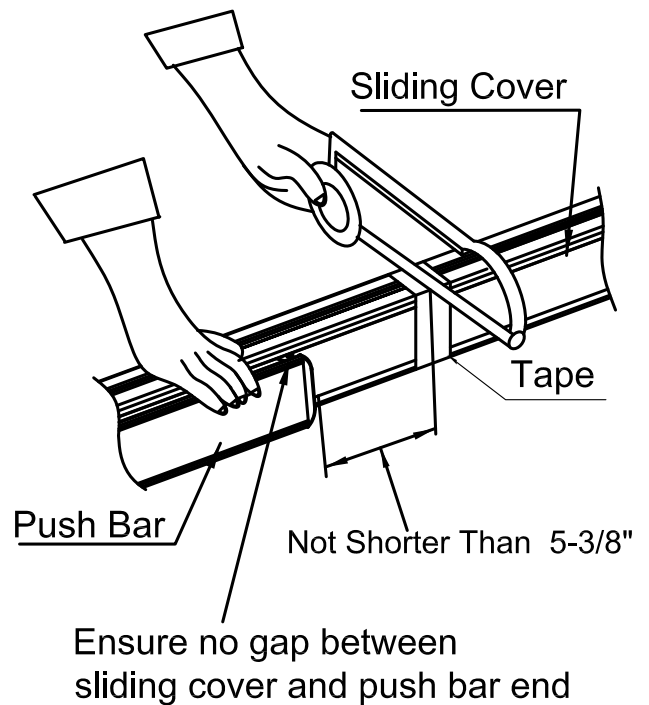
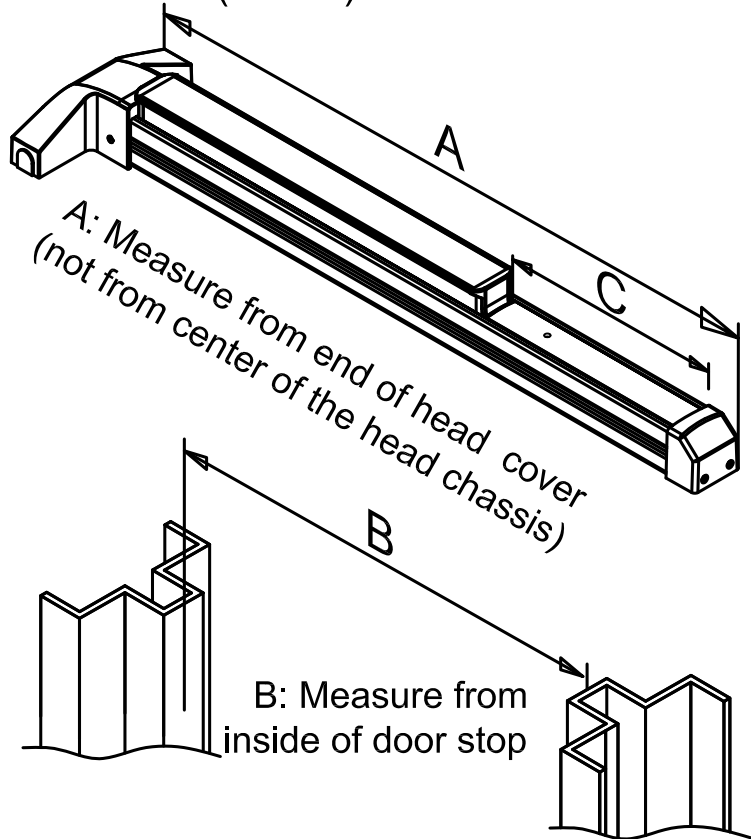

## STEP 4 : EXIT DEVICE INSTALLATION & INSTALL CHASSIS & BRACKET

\*(refer to step9 to ensure handing, before step 4A started)

4A. Take off head cover and then put device horizontally at the door.

4B. Fix chassis by two(2) M6 screws<Only for Fire Rated> two(2) #10 screws.

4C. Install bracket, Be sure to remain device horizontally and then fasten all screws.

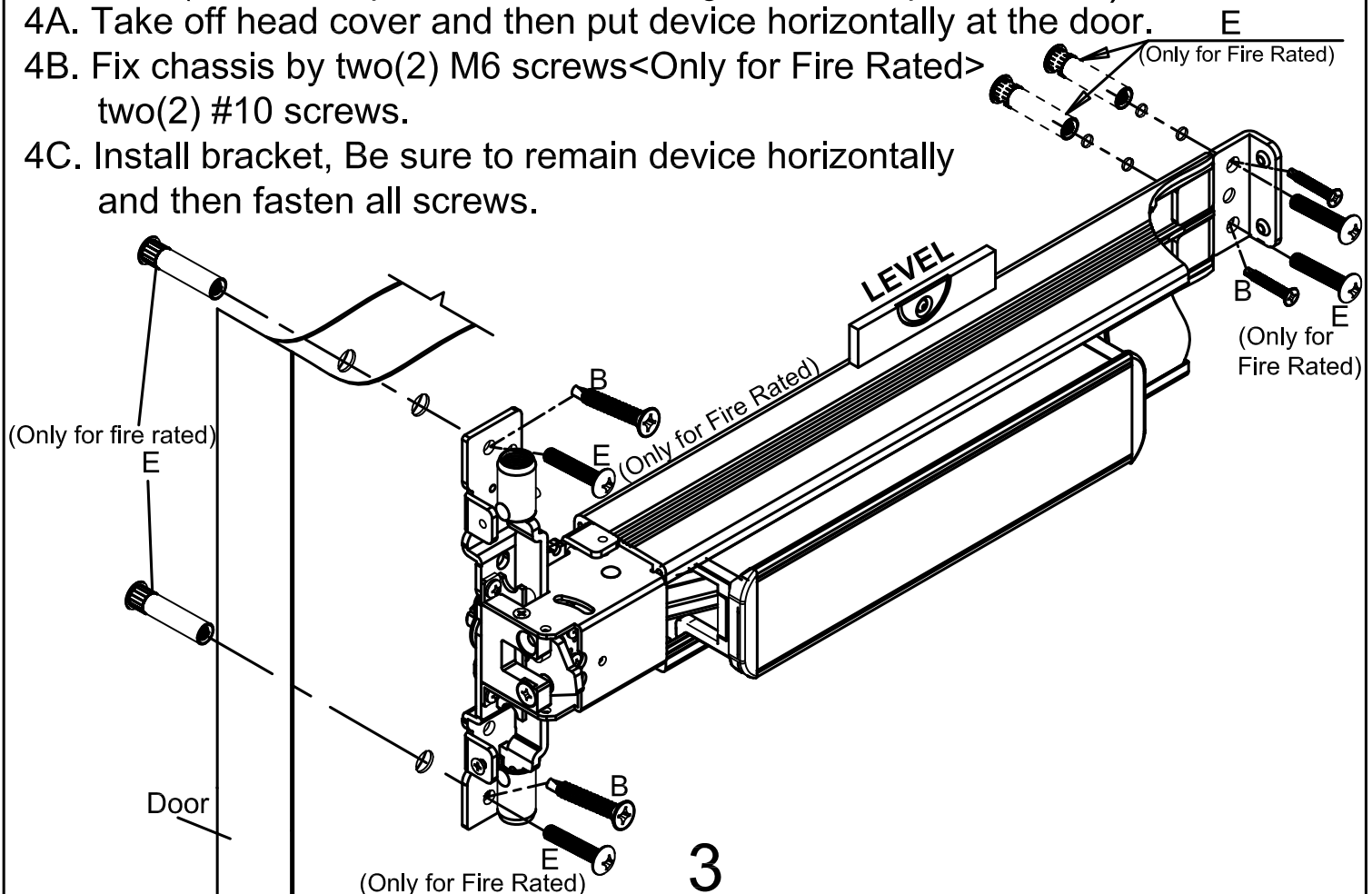

## STEP 5 : INSTALL TOP LATCH & TOP STRIKE

### 5A. INSTALL TOP LATCH

Follow TEMPLATE to install top latch with two screws (F).

<Do not tighten the screws (F) firmly>

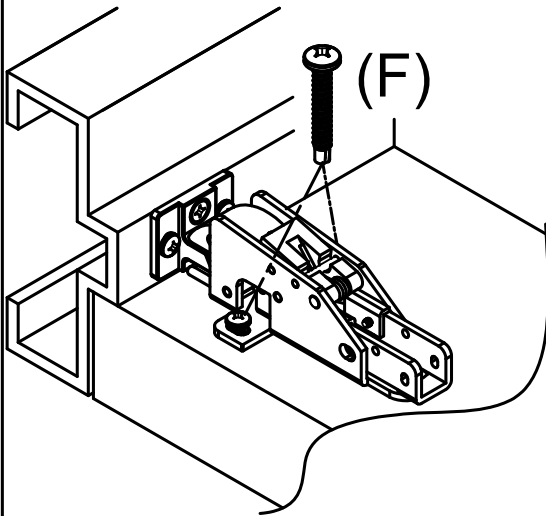

### 5B. INSTALL TOP STRIKE

Follow TEMPLATE to install top strike.

Adjust the proper gap between top latch and strike which is about 5/64" (2.0mm), tighten screws (F) firmly and then screw (B).

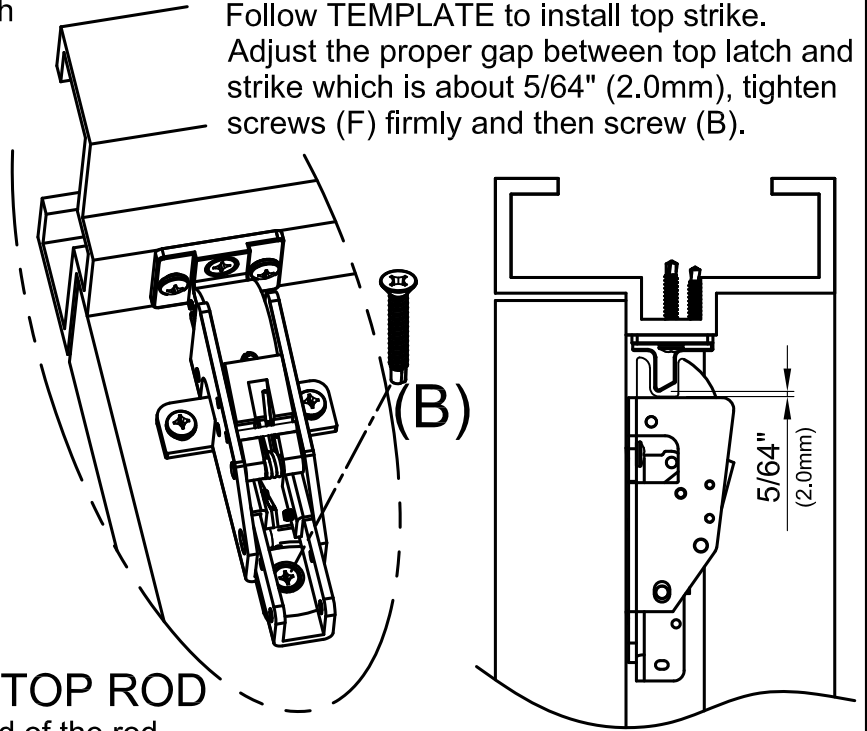

## STEP 6 : INSTALL & ADJUST TOP ROD

The rod length can be adjusted by the thread of the rod, adjust the correct length when door is in the closed position, by aiming the rod to the hole of the part (P).

※ If top rod had been cut to fit door height, please drill hole for pin loading.

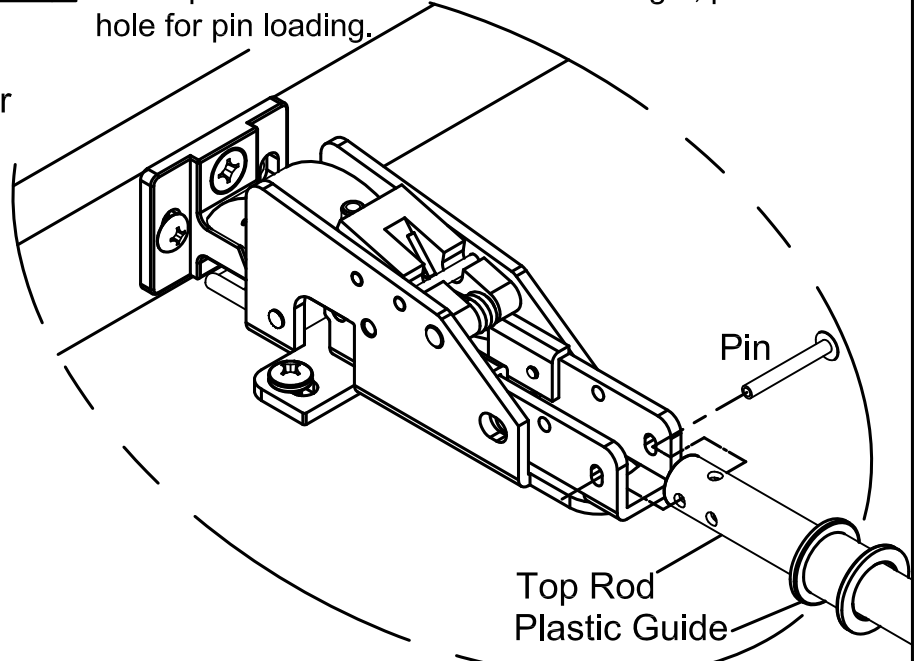
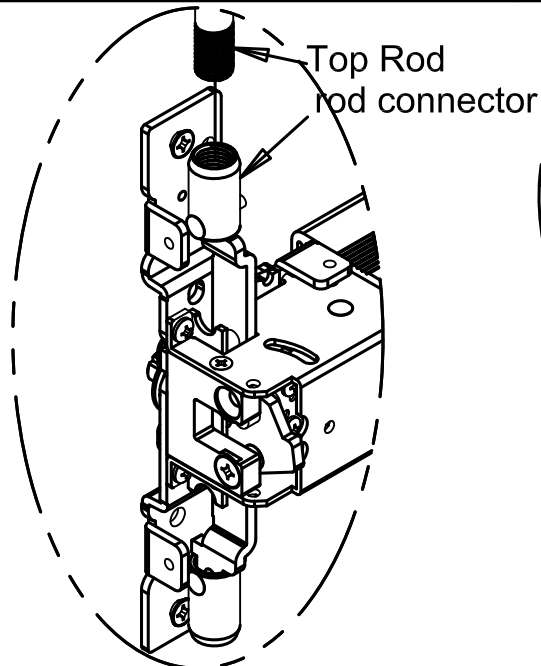

## STEP 7 : Install Head Cover, End Cover ,Latch Cover ,Rod Guide

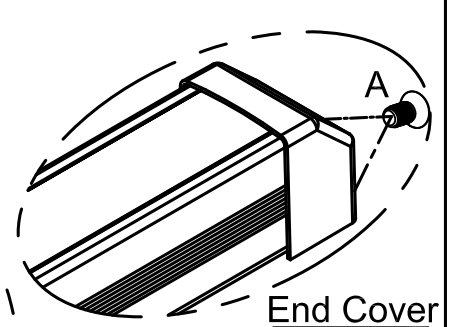
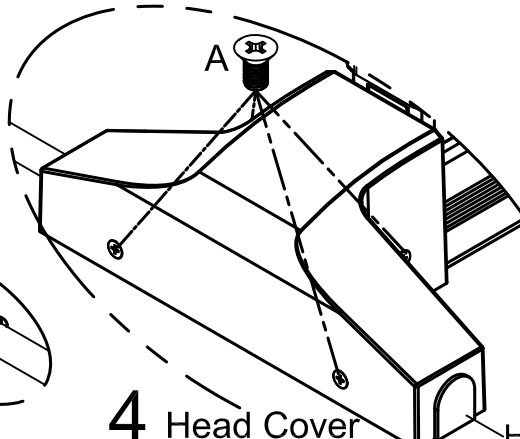
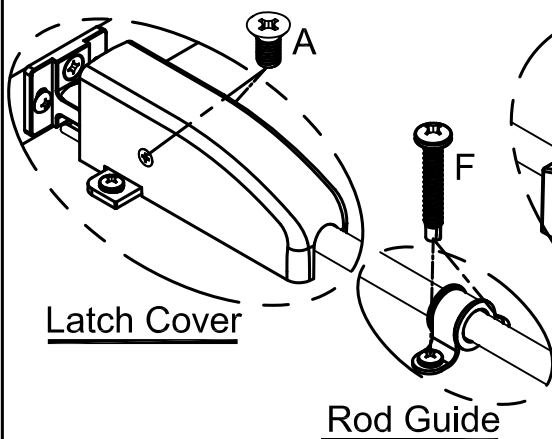

## STEP 8 : TEST PUSH RAIL & THE DOGGING FUNCTION

- 8A. The latches should engage the strikes when the door is closed. If the door can be pushed to open without depressing the push rail, please check the rod length and installation(see step 5)
- 8B. The latches should disengage from the strikes freely when the push rail is depressed or dogged down. If not, please check the rod length and installation again (see step 5)
- 8C. When applying outside trims:
- (1). No trims : Exit only, latch bolts are retracted just by the push rail inside.
  - (2). Entrance : latch bolts are retracted by trim outside after the trim is unlocked.
  - (3). Storeroom : latch bolts are retracted by trim outside with key only.
  - (4). Passage : latch bolts are retracted by trim always open.
- 8D. Dogging: Use dogging hex key and turn clockwise 90° when depressing push rail. Latch bolts will remain retracted.

## STEP 9 : Change Hand of Device (from LHR to RHR)

\*LHR as shown\*

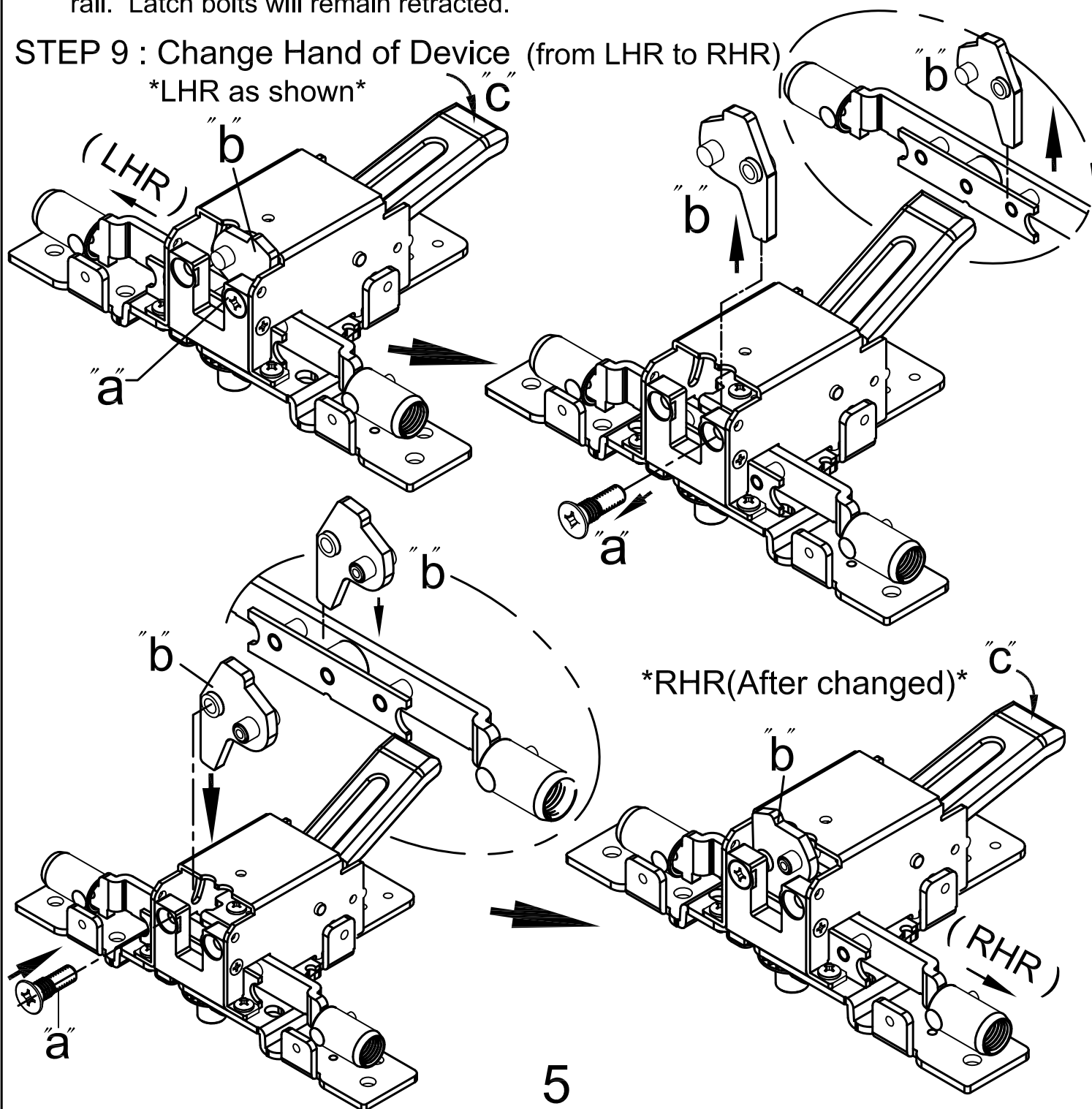

# TEMPLATE of Top LATCH

【Top Strike (regular use)】

(1:1)

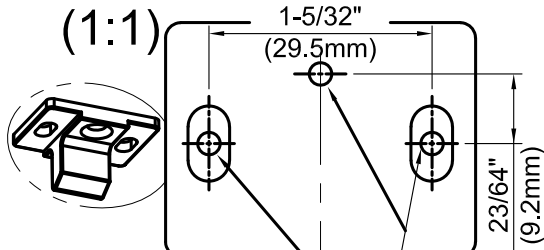

FOLD HERE ON DOTTED LINE

OUTLINE OF BOTTOM CHASSIS  
2-3/8" (60.4mm)

53/64" (21mm) 53/64" (21mm)

LOCATION OF MOUNTING SCREW HOLES

FOR SEX BOLT  
DRILL 3/8" (9.6mm)  
HOLE OUTSIDE

VERTICAL CENTERLINE

