

Heavy Duty Commercial Clutching Mortise Lock “Easily Field Reversible”

INSTALLATION GUIDE

Mortise handing change instruction

Change the latchbolt position

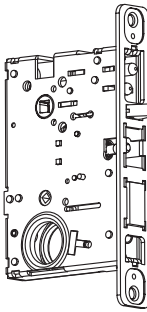
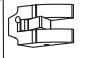
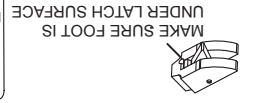
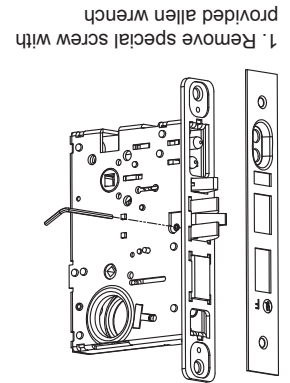

FROM OPPOSITE SIDE
INSERT SPECIAL SCREW
AND TIGHTEN WITH
ALLEN WRENCH

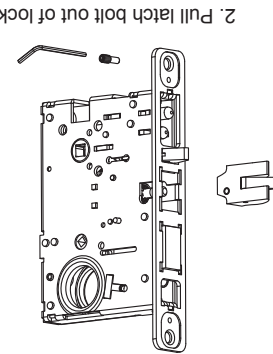

4. Reinstall the special screw and tighten securely with the provided allen wrench.

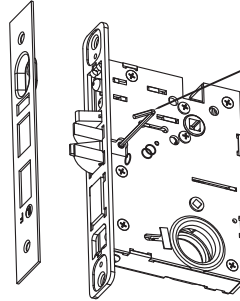

Driver Pin Assembling

