

# GRADE 1 DEADBOLT INSTALLATION INSTRUCTIONS

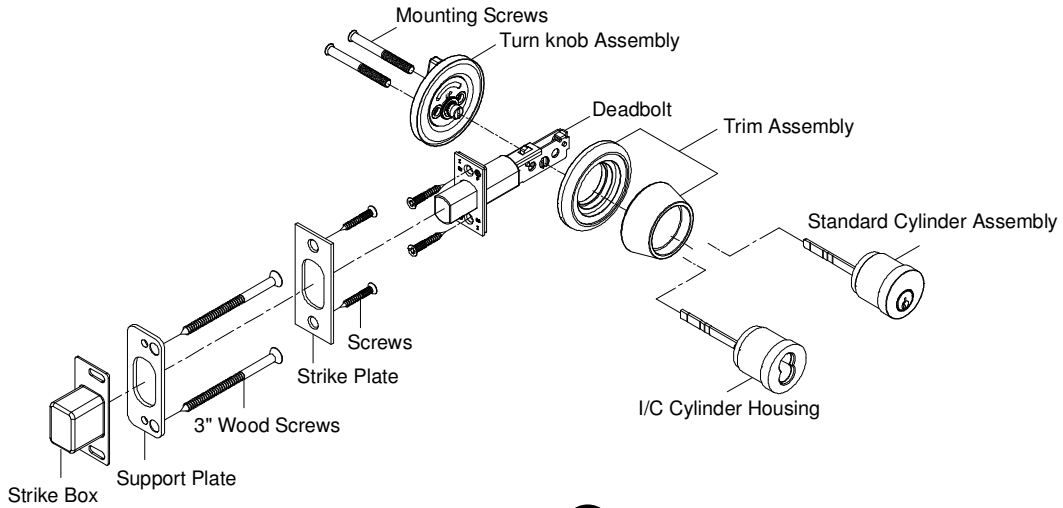

## 1 Mark door

- 1 Place template on door and mark center for 2 1/8" hole at desired backset.
- 2 Template should be placed on high edge of beveled door edge.

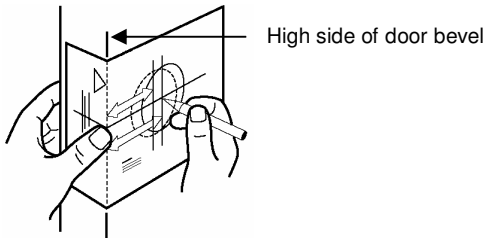

## 2 Bore two holes

- 1 Bore a 2 1/8" diameter hole. To avoid splintering a wood door, bore the hole from both sides of door.
- 2 Drill a 1" diameter hole from the edge of door that intersects the 2 1/8" hole.
- 3 Using the deadbolt faceplate as a guide, mortise the edge of door to recess the faceplate.

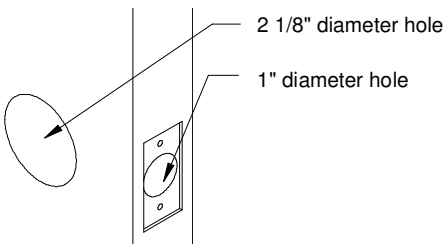

## 3 Prepare door jamb

- 1 Locate exact center of bolt and mark center lines on jamb as shown.
- 2 Mark drill points 5/16" above and below horizontal center line.
- 3 Bore two overlapping 7/8" holes, 1 1/8" deep.
- 4 Clean out holes for strike box and place strike box in hole.
- 5 Place strike over box and trace for cutout.
- 6 Chisel about 1/4" deep for flush fit of strike box, support plate and strike.

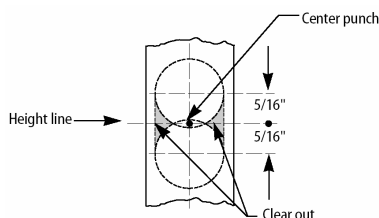

## 4 Install strike plate

- 1 Place support plate with screw holes toward doorstop.
- 2 Mark and drill two 3/16" holes for 3" wood screws.
- 3 Install support plate, strike box, and finish strike in the order shown.
- 4 Test lock with key and turn knob. Bolt must travel and project fully into strike preparation without binding.

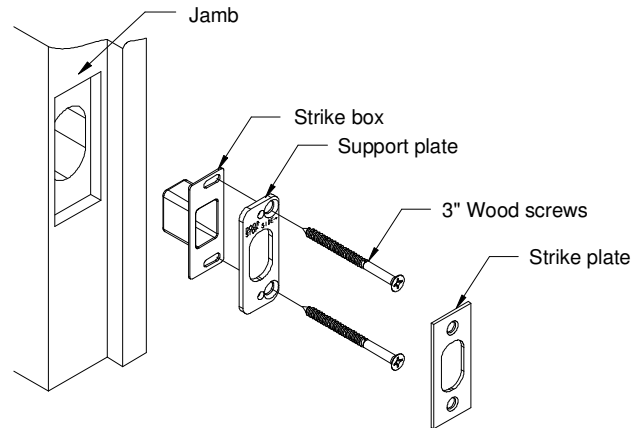

## 5 Install deadbolt assembly

- 1 Insert the deadbolt with slotted spindle hole at the bottom of the assembly.
- 2 Secure the deadbolt to the door with screws.

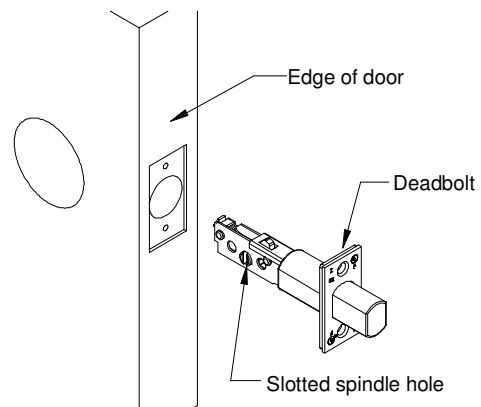

## 6 Install cylinder(s)

### For single cylinder deadbolts:

- 1 Extend the bolt with a screwdriver.
- 2 Install the cylinder and trim assembly with the spindle in the vertical position.

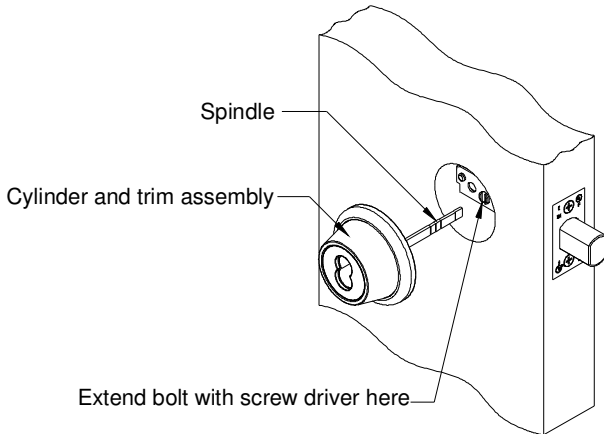

### For double cylinder deadbolts:

- 1 Extend the bolt with a screwdriver.
- 2 Install each cylinder with its ring and rose.
- 3 Insert long mounting screws and tighten.
- 4 Check to make sure the deadbolt operates properly.
- 5 Insert the cover.

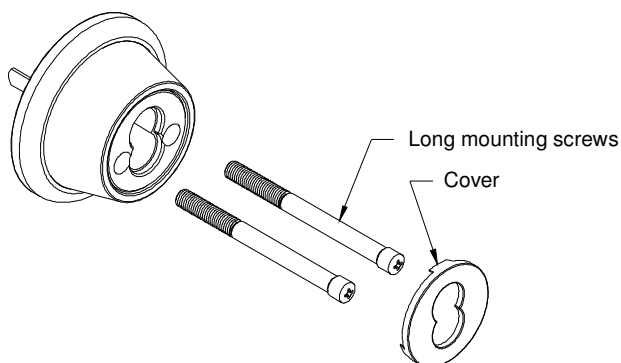
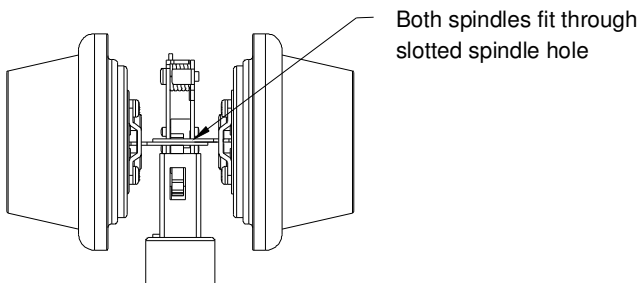

Note 1 : Mount cylinders on the doors so that the mounting screws enter from the inside of the door.

- 2 : Both spindles must fit through the spindle hole in the deadbolt assembly.

## 7 Attach inside trim

- 1 Break the spindle at the appropriate notch to suit the installation.
- 2 Slide the Turn Knob assembly over the spindle and secure it and the cylinder to the door with mounting screws supplied.
- 3 Check to make sure that the deadbolt operates properly.

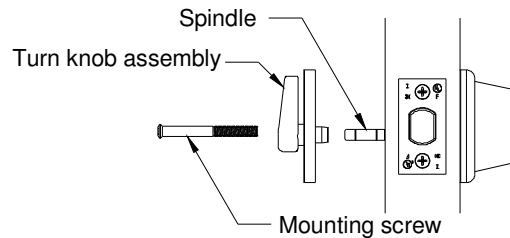

## 8 Install core(s)

- 1 Put the control key into the core and turn the key 15 degrees clockwise.
- 2 Adjust the throw pins if needed, then put the core into the cylinder with the control key.
- 3 Turn the key 15 degrees counterclockwise and remove the key.

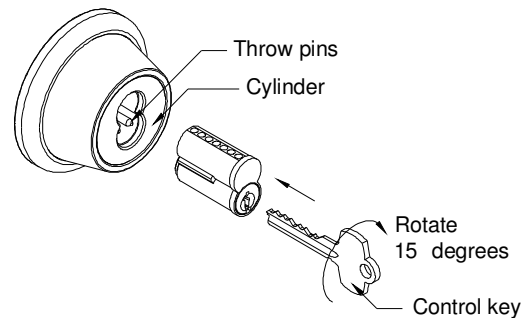

## 9 Replacement of spindle

A spare longer spindle is included in package for door thicker than 1 3/4" (45mm). Replacement of the spindle as shown in figure.

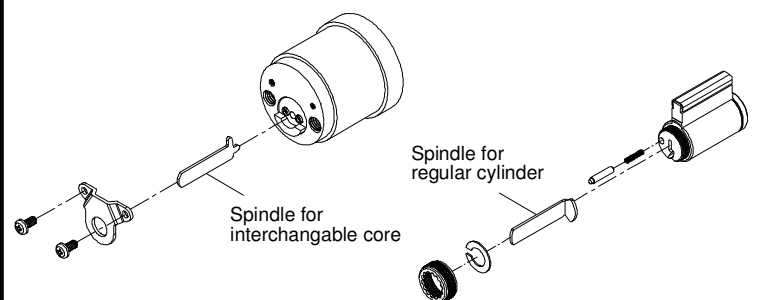

Patents :

Products are protected by one or more of the following U.S. patents: 4725086, 4838053, 5398531, 5713231, 5906125, 5970760. Other patents pending.

**Caution : Double cylinder locks are operated by key only and may hinder emergency exit . Check for applicable fire codes and / or life safety codes before installing double cylinder deadbolt .**