

USING GUIDE PIN TO ALIGN INNER PLATE & INSTALL THUMB TURN

(Note: If using this thumb turn with the ligature resistant indicator on a 1 3/4" thick door there is no need for the spindle.)

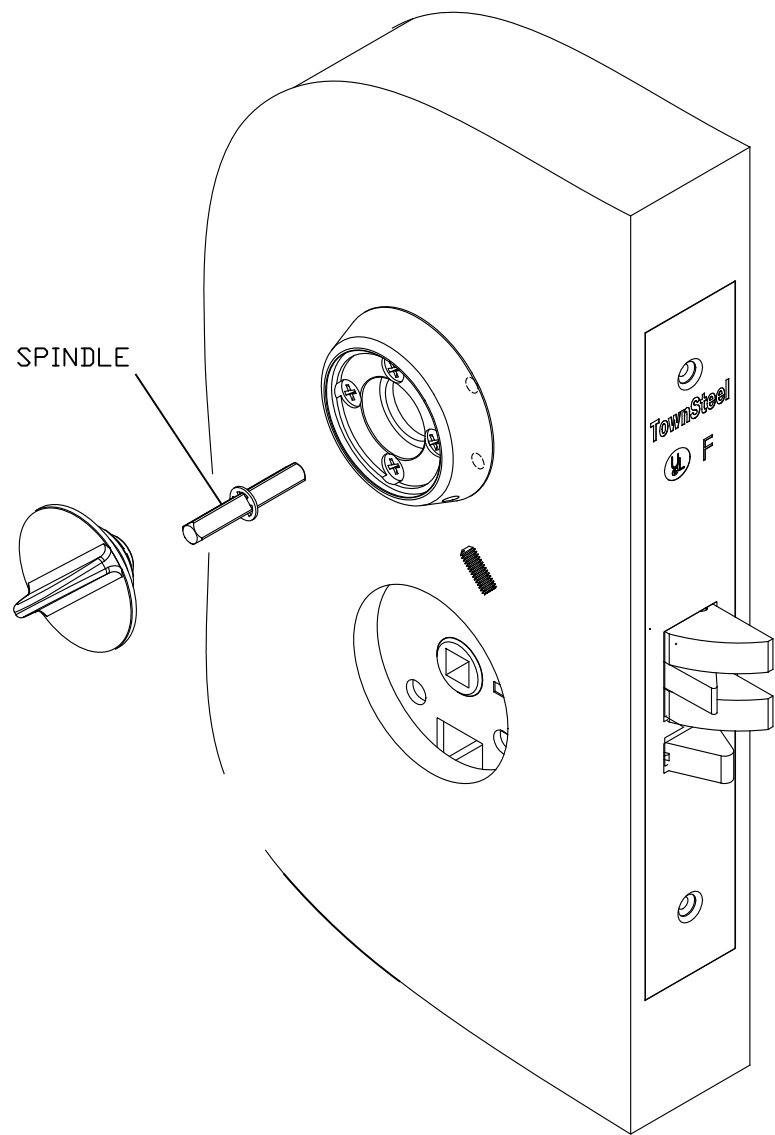
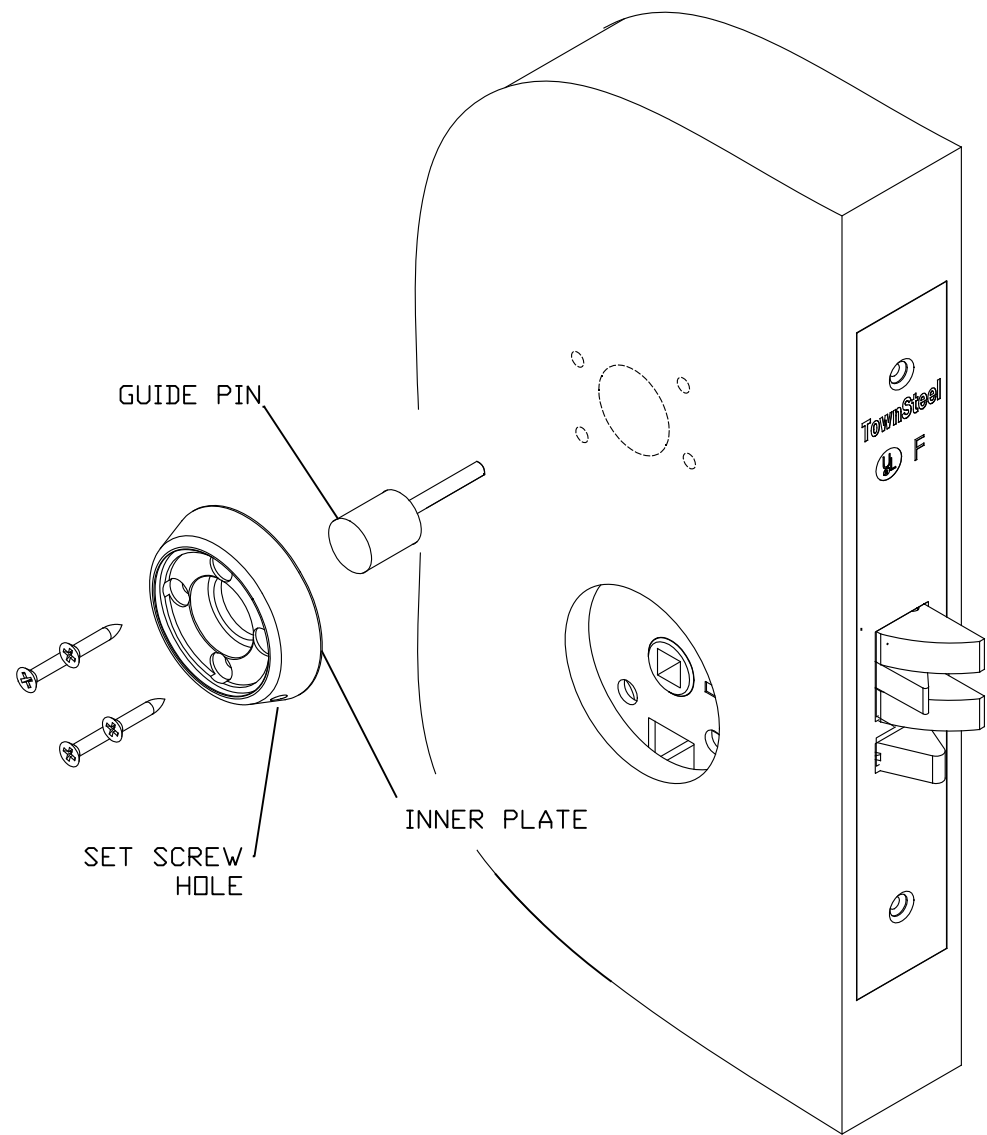

LIGATURE RESISTANT THUMB TURN INSTRUCTIONS

1. PREPARE DOOR PER TEMPLATE. NOTE: ALWAYS LEAVE DOOR OPEN DURING INSTALLATION.
2. USE THE GUIDE PIN TO ALIGN THE INNER PLATE. MATCH DRILL (OR MARK LOCATION AND DRILL) THE 4 HOLES TO MOUNT THE INNER PLATE. PILOT HOLE SIZE FOR #6 SCREW IN A WOOD DOOR IS 5/64". LOCATION OF SET SCREW HOLE TO BE APPROXIMATELY AS SHOWN.
3. MOUNT THE INNER PLATE WITH THE 4 SCREWS AND REMOVE GUIDE PIN.
4. INSTALL THE SPINDLE & THUMB TURN, SCREW IN SET SCREW TO SECURE THE THUMB TURN (DO NOT OVER TIGHTEN).
5. OPERATE THE THUMB TURN TO ENSURE PROPER INSTALLATION, ALIGNMENT AND OPERATION.

TownSteel 17901 RAILROAD STREET CITY OF INDUSTRY, CA 91748	DRAFT UNLESS OTHERWISE SPECIFIED: 1" MAX	<div>B</div> TOLERANCES UNLESS OTHERWISE SPECIFIED: X.X (METRIC) =±0.4 X.XX (METRIC) =±0.15 FRACTIONS = ±.8 ANGLES = ±1/2° ⊙ .12 MACHINED SURFACES 125/ ⊕ ≡ THIRD ANGLE	MATERIAL: NOTED
			HEAT TREAT: N/A
	DRAWN BY: SC		FINISH: 32D
	DATE: 8/14/19		TITLE: MRXL W LIGATURE RESISTANT T-TURN
	PART#: T-TURN 1001 INSTALL		

THIS DRAWING AND THE INFORMATION CONTAINED THEREON OR DERIVED THEREFROM ARE THE CONFIDENTIAL PROPERTY OF TOWNSTEEL, INC. IT IS NOT TO BE REPRODUCED, OR DISCLOSED TO OTHERS, AND MAY BE USED ONLY FOR THE PURPOSE OF ENABLING THE PARTY TO WHOM IT HAS BEEN LOANED TO QUOTE ON OR FILL AN ORDER FOR TOWNSTEEL, INC., OR AS MAY BE OTHERWISE AUTHORIZED BY TOWNSTEEL, INC. IN WRITING.