

LEFT HAND SHOWN

INNER TRIM

OUTER TRIM

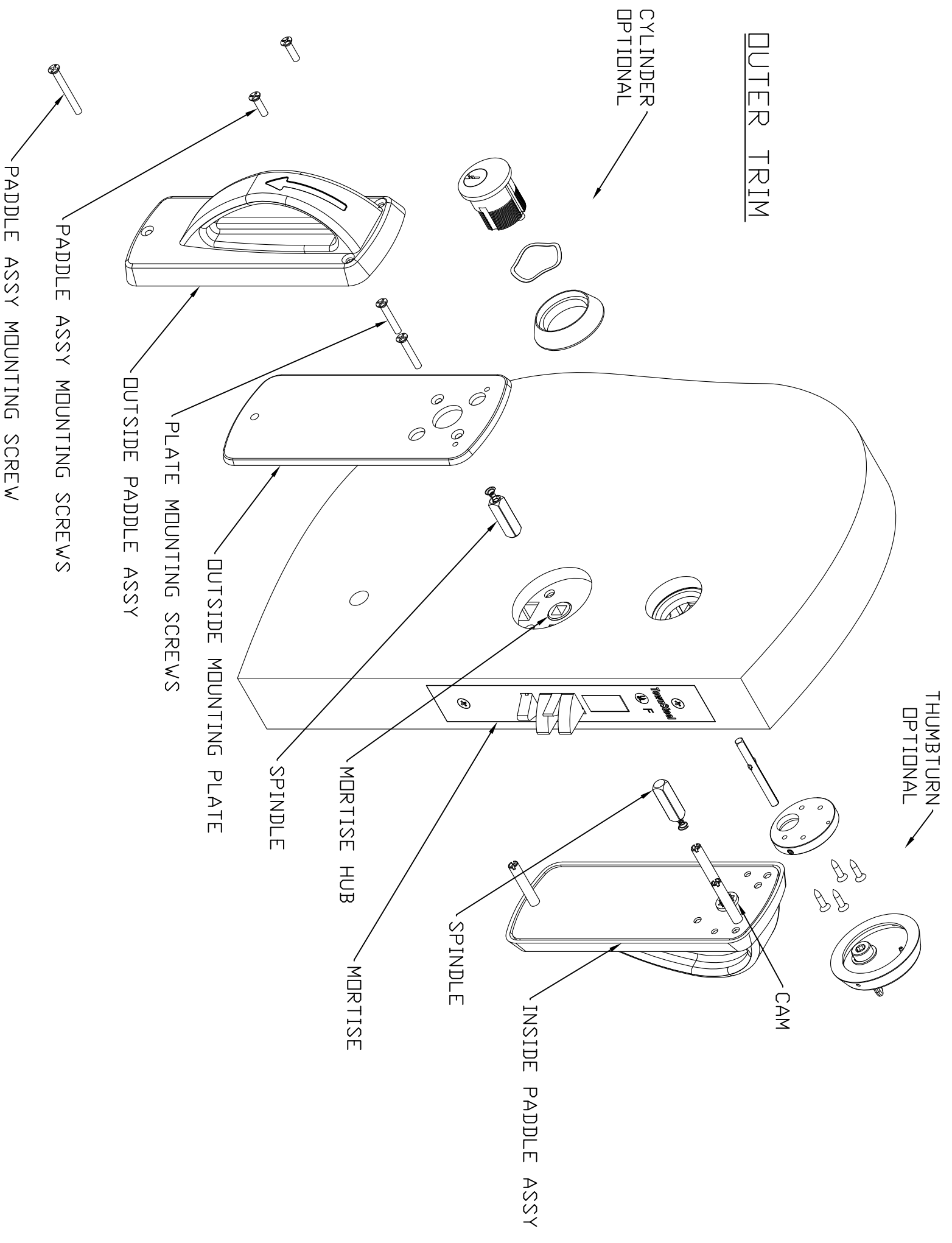

MRXA INSTALLATION GUIDE

1. PREPARE DOOR CUTOUT PER TEMPLATE.
  2. INSTALL MORTISE INTO THE PREPARED DOOR (SEE MORTISE INSTRUCTIONS FOR HANDING INSTRUCTIONS).
  3. INSTALL SPINDLES IN MORTISE. NOTE: SPRING FACES OUT, SEE ORIENTATION ON EXPLODED VIEW.
  4. SLIDE INSIDE PADDLE ASSEMBLY ONTO THE MORTISE WITH POSTS GOING THROUGH THE MORTISE THROUGH HOLES WITH THE SPINDLE ENGAGING THE CAM ON THE I/S ASSY.
  5. ON THE OUTSIDE - POSITION THE OUTSIDE MOUNTING PLATE AND PUT THE 2 PLATE MOUNTING SCREWS THROUGH HOLES ON THE OUTSIDE MOUNTING PLATE. ALIGN THE SCREWS WITH THE POSTS AND TIGHTEN.
  6. POSITION THE OUTSIDE PADDLE ASSEMBLY OVER THE OUTSIDE MOUNTING PLATE WITH THE SPINDLE ENGAGING THE CAM ON THE O/S PADDLE ASSEMBLY. USE THE 3 PADDLE ASSY MOUNTING SCREWS TO SECURE THE ASSEMBLY.
- NOTE: ONCE THE PADDLE ASSEMBLY IS SET ON BOTH SIDES- SLIDE THE PADDLE (DOWN) ON BOTH SIDES TO ENSURE THE MORTISE LATCH RETRACTS AND THERE IS NO BINDING. IF THE LATCH OR PADDLE BINDS REMOVE THE PADDLE ASSEMBLY FROM THE MOUNTING SCREW SIDE AND LOOSEN THE MOUNTING SCREWS AND ALIGN THE OUTSIDE MOUNTING PLATE AND THE INSIDE PADDLE ASSY WITH THE CENTER OF THE MORTISE HUBS AS MUCH AS POSSIBLE UNTIL NO BINDING OCCURS. TIGHTEN THE SCREWS AND RETRY.
7. OPTIONAL - INSTALL CYLINDER (COLLAR, WAVE WASHER, CYLINDER) AND SECURE WITH SET SCREW (UNDER MORTISE FACE PLATE). INSTALL THUMBTURN.
  8. CHECK LOCK FOR CORRECT OPERATION BEFORE CLOSING THE DOOR.

DRAFT UNLESS OTHERWISE SPECIFIED: 1° MAX	A	TOLERANCES UNLESS OTHERWISE SPECIFIED: XX (METRIC) =±0.4 XXX (METRIC) =±0.15 FRACTIONS = ±.8 ANGLES = ±1/2° MACHINED SURFACES 125/ THIRD ANGLE	MATERIAL: N/A HEAT TREAT: N/A FINISH: N/A
DRAWN BY: SC			TITLE: MRXA HORIZONTAL MOUNTING INSTRUCTIONS
DATE: 7/24/13			PART#: MRXA MTG INSTR

FIG 1

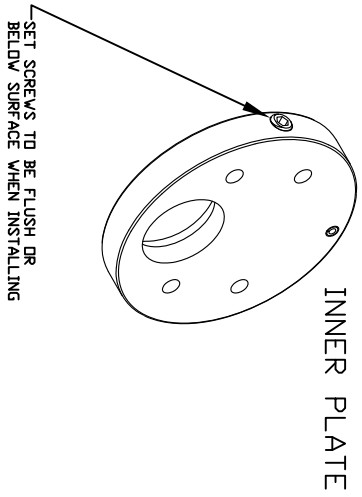

INNER PLATE

FIG 2

IN BOTH HOLES IN THE THUMB TURN, PLACE A 5/16" ALLEN WRENCH (PROVIDED) THROUGH THE HOLE IN THE SET SCREW IN THE INNER PLATE AND SECURE THE THUMB TURN BY TURNING COUNTER-CLOCKWISE (TO REMOVE ROTATE CLOCKWISE).

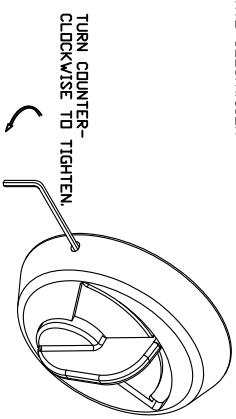

REV

DESCRIPTION

DATE

EXPLODED VIEW

USING GUIDE PIN TO ALIGN INNER PLATE

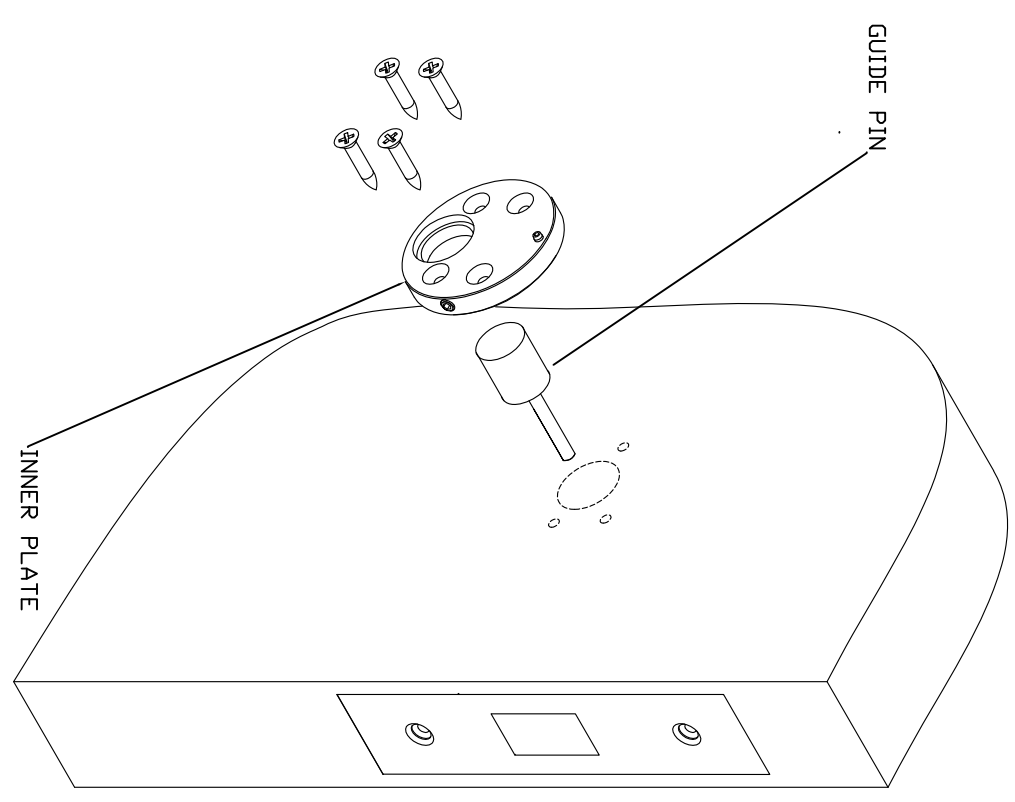
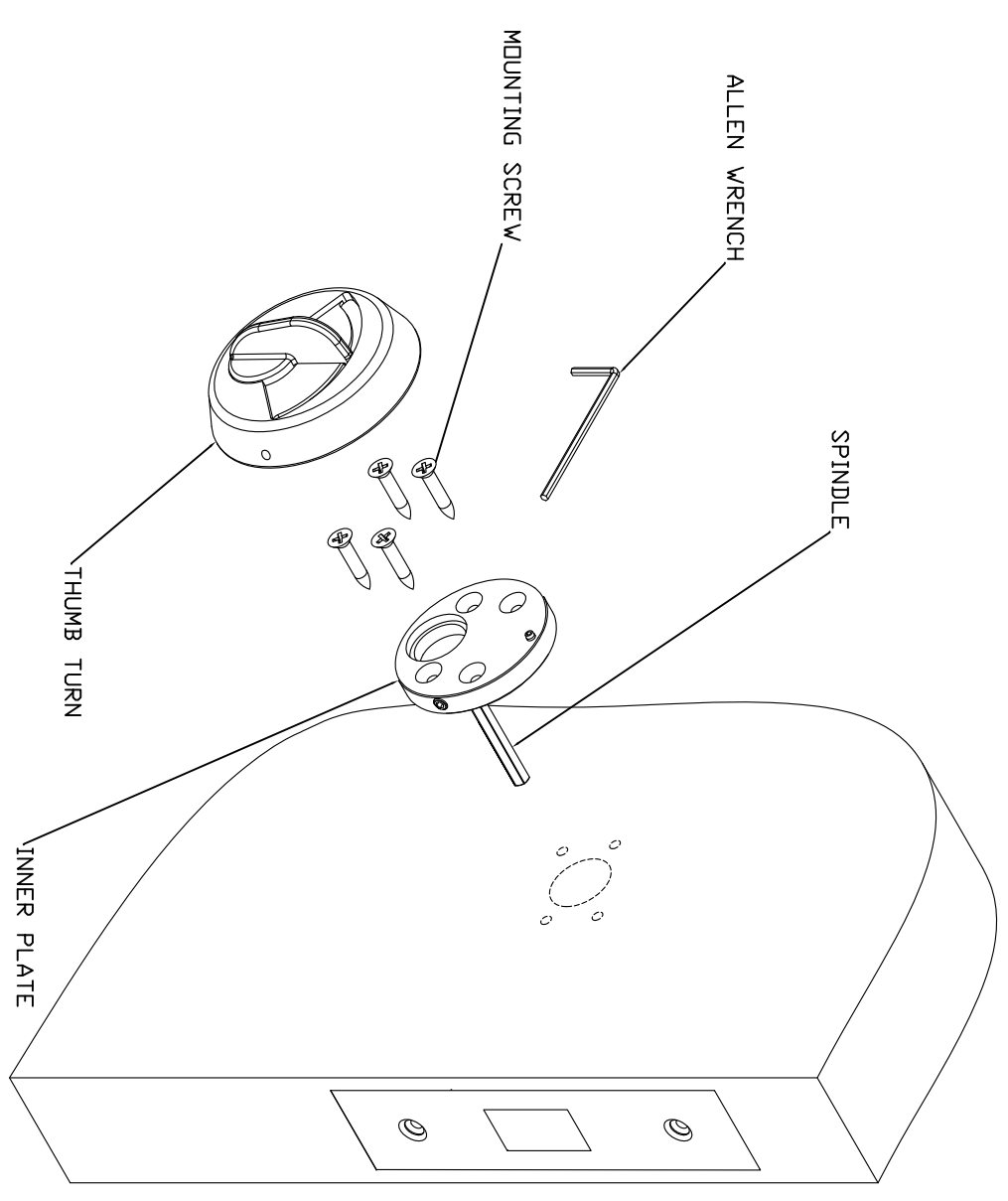

HOSPITAL THUMB TURN INSTRUCTIONS

1. PREPARE DOOR PER TEMPLATE.
2. USE THE GUIDE PIN TO HELP ALIGN THE INNER PLATE. MATCH DRILL (OR MARK LOCATION AND DRILL) THE 4 HOLES TO MOUNT THE INNER PLATE. PILOT HOLE SIZE FOR #6 SCREW IN A WOOD DOOR IS  $\frac{3}{4}$ ".
3. MOUNT THE INNER PLATE WITH THE 4 SCREWS.
4. INSTALL THE SPINDLE AND THUMB TURN (SEE EXPLODED VIEW).
5. OPERATE THE LOCK TO ENSURE PROPER INSTALLATION AND ALIGNMENT.
6. TIGHTEN THE THUMB TURN ONTO THE INNER PLATE - SEE FIG 1 & 2. INSERT THE ALLEN WRENCH THROUGH EACH HOLE (2 IN EACH INNER PLATE) TO ENGAGE THE SET SCREW AND SECURE THE THUMB TURN ASSEMBLY. ROTATE COUNTERCLOCKWISE TO TIGHTEN IN THE ASSEMBLY AND ROTATE CLOCKWISE TO LOOSEN. SEE FIG 1 & 2.
7. CHECK LOCK FOR CORRECT OPERATION BEFORE CLOSING THE DOOR.

<p><b>TownSteel</b> 707 N. BARRANCA AVE #6 Covina, Calif 91723</p>		DRAFT UNLESS OTHERWISE SPECIFIED: 1" MAX	<p><b>B</b></p> <p>UNLESS OTHERWISE SPECIFIED: XX (METRIC) = ±0.4 XXX (METRIC) = ±0.15 FRACTIONS = ±.8 ANGLES = ±1/2° MACHINED SURFACES 125/ THIRD ANGLE</p>	MATERIAL: NOTED
		DRAWN BY: SC		HEAT TREAT: NA
DATE: 10/7/11				TITLE: ADA THUMB TURN ASSY INSTRUCTIONS
				PART#: ADA-TURN

THIS DRAWING AND THE INFORMATION CONTAINED THEREON OR DERIVED THEREFROM ARE THE CONFIDENTIAL PROPERTY OF TOWNSTEEL, INC. IT IS NOT TO BE REPRODUCED, OR DISCLOSED TO OTHERS, AND MAY BE USED ONLY FOR THE PURPOSE OF ENABLING THE PARTY TO WHOM IT HAS BEEN LOANED TO QUOTE ON OR FILL AN ORDER FOR TOWNSTEEL, INC., OR AS MAY BE OTHERWISE AUTHORIZED BY TOWNSTEEL, INC. IN WRITING.

# INSTALLATION GUIDE FOR ELECTRIFIED MORTISES - SOLENOID ONLY

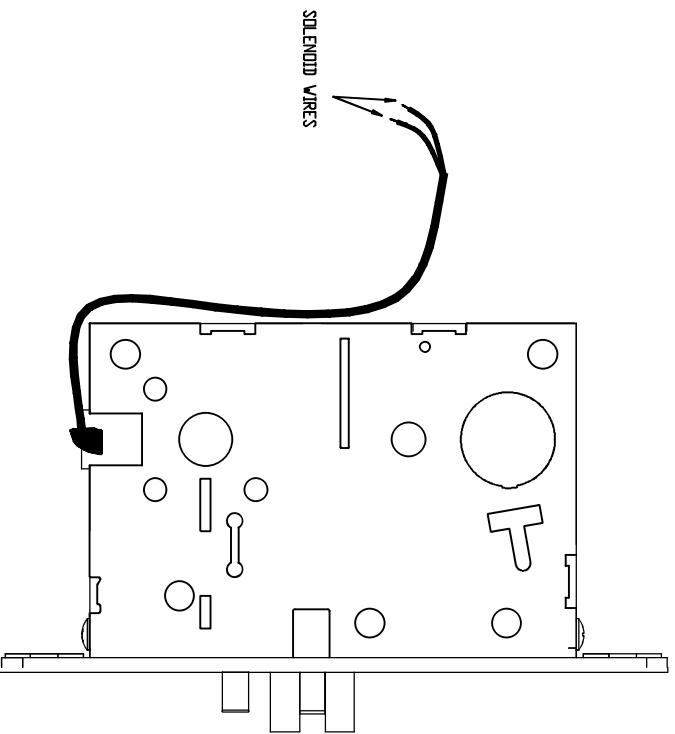

## INSTRUCTIONS

1. PREPARE MORTISE POCKET IN DOOR PER TEMPLATE. ACCESS FOR THE WIRING TO BE PER INSTALLERS REQUIREMENTS. IT IS RECOMMENDED THAT AN ACCESS CHANNEL IS BORED TO PROVIDE CONTACT FROM THE ELECTRIC TRANSFER HINGE OR OTHER MEANS OF TRANSFER TO THE MORTISE POCKET.
2. CONNECT WIRES AS NECESSARY AND SLIP THE MORTISE INTO THE PREPARED POCKET IN THE DOOR. TAKE CARE TO ENSURE WIRES ARE NOT PINCHED OR DAMAGED. NOTE: IT IS RECOMMENDED THAT ALL WIRING BE DONE BY A LICENSED ELECTRICIAN FAMILIAR WITH THE SUPPORTING EQUIPMENT.
3. ALWAYS ENSURE DOOR OPERATES PROPERLY BEFORE LOCKING.

## SPECIFICATIONS:

SOLENOID (SPECIFIED BY MODEL NUMBER):

24VDC	114.7+10%-0 Ω	WIRE SIZE	24AWG	OPERATE AT	24VDC±10%
12VDC	28.8+10%-0 Ω	WIRE SIZE	24AWG	OPERATE AT	12VDC±10%

## TERMS

FAIL SECURE- OUTER TRIM IS UNLOCKED WHEN POWER IS APPLIED. WHEN POWER IS REMOVED THE OUTER TRIM REMAINS LOCKED.

FAIL SAFE- OUTER TRIM IS LOCKED WHEN POWER IS APPLIED. WHEN POWER IS REMOVED THE OUTER TRIM REMAINS UNLOCKED.